

2022



CATÁLOGO DE PRODUCTOS LABMED

Apoyando el desarrollo de sus proyectos

Contents

Cell Culture Plates	01	Microcentrifuge Tubes	23
Culture Inserts	03	Micro Tube Boxes	23
EDGE Plates	05	50 mL Centrifuge Tubes	24
Glass Bottom Cell Culture Dishes& Plates	06	Screw Cap Tubes	24
Cell Culture Dishes	07	Pipette Tips	25
Cell Culture Flasks	08	Automation Tips	26
Cell Scrapers	09	Pasteur Pipettes	26
5-Layer Cell Culture Flasks	09	Serological Pipettes	27
Biofactory™	10	Reagent Reservoirs	28
Biofactory™ Accessories	12	Elisa Plates(Immunoplates)	29
Mini Bioreactors	13	Cuvettes	29
PETG Erlenmeyer Flasks	13	PCR Tubes & Caps	30
PC Erlenmeyer Flasks	14	PCR Plates	31
3D Barcode Cryogenic Vial	14	Deep Well Plates	38
Cryogenic Vials	15	Deep Well Plates & Plastic Comb	38
Cryogenic 2D Matrix Vials	16	Petri Dishes	39
Colored Inserts	17	L-Spreaders	40
Cryo Boxes	17	Innoculating Needles / Loops	40
Ice Free Cool Box	17	Nonwoven Masks/Mushroom Caps	41
Square shape PET Media Bottles	19	Non-woven Shoe Covers	41
Round Storage Bottles	19	Nitrile / Latex Examination Gloves	42
Vacuum Filtration Systems	20	Centrifuge / 7° Digital Nutating Mixer	44
Syrings Filters	20	Mini Metal Bath/Mini Vortex Mixer	45
Centrifuge Tubes	21	Variable Speed Tube Revolver	
Cell Strainers	21	With Digital Display	46
Centrifuge Tubes	22	Standard Mini Roller	47
Centrifuge Tube Racks	22	CO ₂ Orbital Shaker	48

New Product Guide



Culture Inserts
(page 3)



EDGE Plates
(page 5)



35mm TC Dishes With Gripping Ring
(page 7)



50mL Mini Bioreactors
(page 13)



2L/3L/5L Erlenmeyer Flasks
(page 14)



3D Barcode Cryogenic Vial
(page 14)



Ice Free Cool Box
(page 17)



Ice Free Cool Box
(page 18)



Square shape PET Media Bottles
(page 19)



Round Storage Bottles
(page 19)



Vacuum Filtration Systems
(page 20)



Syringes Filters
(page 20)



Amber Centrifuge Tubes
(page 21)



Amber Microcentrifuge Tubes
(page 23)



5ML Centrifuge Tubes
(page 24)



Screw Cap Tubes
(page 24)

New Product Guide



Automation Tips
(page 26)



Cuvettes
(page 29)



PCR New Products
(page 31)



Deep Well Plates&Plastic Comb
(page 38)

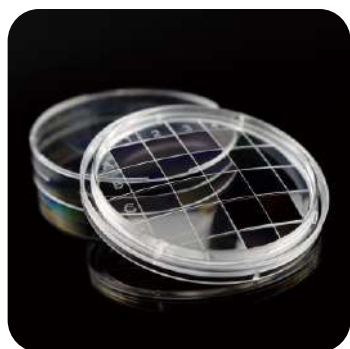

RODAC Dishes
(page 39)



L-Spreaders
(page 40)



Centrifuge
(page 44)



Mini Metal Bath
(page 45)



Mini Vortex Mixer
(page 45)



Variable Speed Tube Revolver
With Digital Display
(page 46)



7° Digital Nutating Mixer
(page 45)



Standard Mini Roller (6 Rollers)
(page 47)



Standard Mini Roller (11 Rollers)
(page 47)

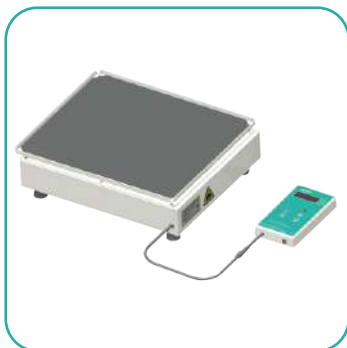





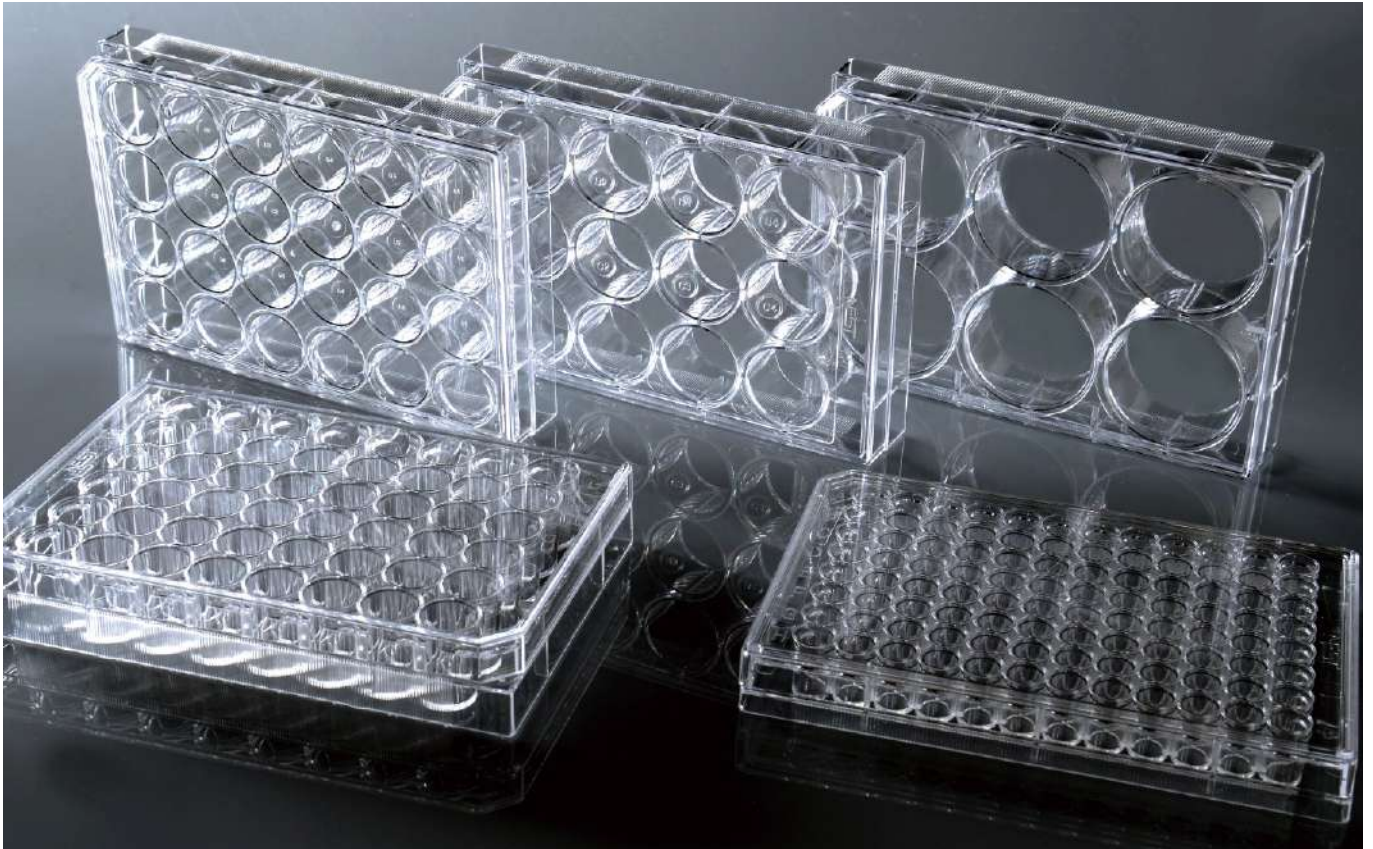

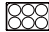

CO₂ Orbital Shaker
(page 48)

Cell Culture Plates



Tissue Culture Treated Plates (Individually Wrapped)

Cat.No.	Spec (Well)	Cell Growth Area (cm ²)	Rcommended Medium Volume (mL)	Bottom	Colour	/Case	
703001	6	9.5	1.9-2.9	Flat	Transparent	50	
712001	12	3.6	0.76-1.14	Flat	Transparent	50	
702001	24	1.9	0.38-0.57	Flat	Transparent	50	
748001	48	0.88	0.19-0.285	Flat	Transparent	50	
701001	96	0.32	0.1-0.2	Flat	Transparent	100	
701101	96	0.32	0.1-0.2	U	Transparent	100	
701201	96	0.32	0.1-0.2	V	Transparent	100	
761001	384	0.11	0.025-0.05	Flat	Transparent	100	
761301	384	0.11	0.025-0.05	Flat	black	100	
761601	384	0.11	0.025-0.05	Flat	white	100	

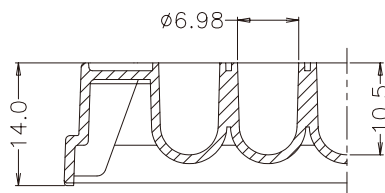
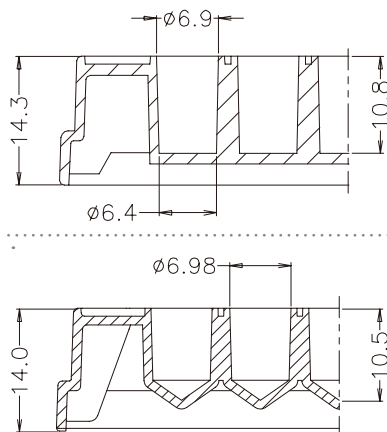

• 96 Well (Flat Bottom)

• 96 Well (U-Bottom)

• 96 Well (V-Bottom)

unit : mm



Excellent bottom uniformity

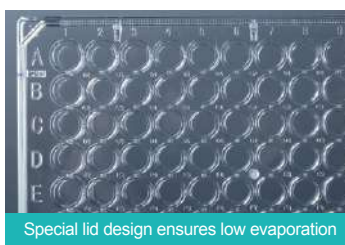

Special lid design ensures low evaporation

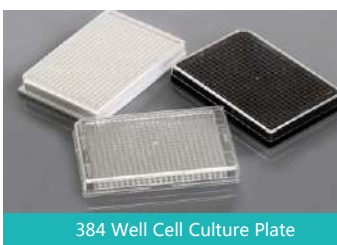

384 Well Cell Culture Plate



Bulk Pack

- High clarity, 100% virgin polystyrene;
- Sterilized by E-beam;
- Clear lot number for batch traceability;
- Non-Pyrogenic, DNase/RNase Free;
- The package box of Nest cell culture plates can be used as reservoirs.

Non-treated Cell Culture Plates (Individually Wrapped)

Cat.No.	Spec (Well)	Cell Growth Area (cm ²)	Rcommended Medium Volume (mL)	Bottom	Colour	/Case
703011	6	9.5	1.9-2.9	Flat	Transparent	50
712011	12	3.6	0.76-1.14	Flat	Transparent	50
702011	24	1.9	0.38-0.57	Flat	Transparent	50
748011	48	0.88	0.19-0.285	Flat	Transparent	50
701011	96	0.32	0.1-0.2	Flat	Transparent	100
701111	96	0.66	0.1-0.2	U	Transparent	100
701211	96	0.41	0.1-0.2	V	Transparent	100
761011	384	0.11	0.025-0.05	Flat	Transparent	100
761311	384	0.11	0.025-0.05	Flat	black	100
761611	384	0.11	0.025-0.05	Flat	white	100



Tissue Culture Treated Plates (Bulk Pack) 10 Pcs/Pack

Cat.No.	Spec (Well)	Cell Growth Area (cm ²)	Rcommended Medium Volume (mL)	Bottom	Colour	/Case
703002 ▲	6	9.5	1.9-2.9	Flat	Transparent	50
712002 ▲	12	3.6	0.76-1.14	Flat	Transparent	50
702002 ▲	24	1.9	0.38-0.57	Flat	Transparent	50
701002 ▲	96	0.32	0.1-0.2	Flat	Transparent	100
761002 ▲	384	0.11	0.025-0.05	Flat	Transparent	100



▲ Make To Order

Non-treated Cell Culture Plates (Bulk Pack) 10 Pcs/Pack

Cat.No.	Spec (Well)	Cell Growth Area (cm ²)	Rcommended Medium Volume (mL)	Bottom	Colour	/Case
703012 ▲	6	9.5	1.9-2.9	Flat	Transparent	50
712012 ▲	12	3.6	0.76-1.14	Flat	Transparent	50
702012 ▲	24	1.9	0.38-0.57	Flat	Transparent	50
701012 ▲	96	0.32	0.1-0.2	Flat	Transparent	100
761012 ▲	384	0.11	0.025-0.05	Flat	Transparent	100



▲ Make To Order

Culture Insert New



Translucent PC Membrane Cell Insert, Tissue Culture Treated (1 Pcs/Pack, 10 Pcs/Case)

Cat.No.	Well	Pore Size (um)	Membrane Density	Insert Membrane Growth Area(cm ²)	Insert Diameter (mm)	Well Volume (ml)	Insert Volume (ml)	Insert Number
723101 ▲	6	0.4	4 x 10 ⁶ well/cm ²	4.67	24	2.6	1.5	6
724101 ▲	12	0.4	4 x 10 ⁶ well/cm ²	1.12	12	1.5	0.5	12
725101 ▲	24	0.4	4 x 10 ⁶ well/cm ²	0.33	6.5	0.6	0.1	12
723001	6	3	2 x 10 ⁶ well/cm ²	4.67	24	2.6	1.5	6
724001	12	3	2 x 10 ⁶ well/cm ²	1.12	12	1.5	0.5	12
725001	24	3	2 x 10 ⁶ well/cm ²	0.33	6.5	0.6	0.1	12
724201 ▲	12	5	/	1.12	12	1.5	0.5	12
725201 ▲	24	5	/	0.33	6.5	0.6	0.1	12
723301 ▲	6	8	1 x 10 ⁵ well/cm ²	4.67	24	2.6	1.5	6
724301 ▲	12	8	1 x 10 ⁵ well/cm ²	1.12	12	1.5	0.5	12
725301 ▲	24	8	1 x 10 ⁵ well/cm ²	0.33	6.5	0.6	0.1	12

▲ Make To Order

Translucent PC Membrane Cell Insert, Non-treated (1 Pcs/Pack, 10 Pcs/Case)

Cat.No.	Well	Pore Size (um)	Membrane Density	Insert Membrane Growth Area(cm ²)	Insert Diameter (mm)	Well Volume (ml)	Insert Volume (ml)	Insert Number
723111 ▲	6	0.4	4 x 10 ⁶ well/cm ²	4.67	24	2.6	1.5	6
724111 ▲	12	0.4	4 x 10 ⁶ well/cm ²	1.12	12	1.5	0.5	12
725111 ▲	24	0.4	4 x 10 ⁶ well/cm ²	0.33	6.5	0.6	0.1	12
723011	6	3	2 x 10 ⁶ well/cm ²	4.67	24	2.6	1.5	6
724011	12	3	2 x 10 ⁶ well/cm ²	1.12	12	1.5	0.5	12
725011	24	3	2 x 10 ⁶ well/cm ²	0.33	6.5	0.6	0.1	12
724211 ▲	12	5	/	1.12	12	1.5	0.5	12
725211 ▲	24	5	/	0.33	6.5	0.6	0.1	12
723311 ▲	6	8	1 x 10 ⁵ well/cm ²	4.67	24	2.6	1.5	6
724311 ▲	12	8	1 x 10 ⁵ well/cm ²	1.12	12	1.5	0.5	12
725311 ▲	24	8	1 x 10 ⁵ well/cm ²	0.33	6.5	0.6	0.1	12

▲ Make To Order

Translucent PC Membrane Cell Insert, Tissue Culture Treated (1 Pcs/Pack, 10 Pcs/Case)

Cat.No.	Name	Pore Size (um)	Membrane Density	Insert Membrane Growth Area(cm ²)	Insert Diameter (mm)	Well Volume (ml)	Insert Volume (ml)
726001	100mm Dish	3	2 x 10 ⁶ well/cm ²	44	75	13	9

Transparent PET Membrane Cell Insert, Tissue Culture Treated (1 Pcs/Pack, 10 Pcs/Case)

Cat.No.	Well	Pore Size (um)	Membrane Density	Insert Membrane Growth Area(cm ²)	Insert Diameter (mm)	Well Volume (ml)	Insert Volume (ml)	Insert Number
723121 ▲	6	0.4	1 x 10 ⁸ well/cm ²	4.67	24	2.6	1.5	6
724121 ▲	12	0.4	1 x 10 ⁸ well/cm ²	1.12	12	1.5	0.5	12
725121 ▲	24	0.4	1 x 10 ⁸ well/cm ²	0.33	6.5	0.6	0.1	12
723021 ▲	6	3	2 x 10 ⁶ well/cm ²	4.67	24	2.6	1.5	6
724021 ▲	12	3	2 x 10 ⁶ well/cm ²	1.12	12	1.5	0.5	12
725021 ▲	24	3	2 x 10 ⁶ well/cm ²	0.33	6.5	0.6	0.1	12

▲ Make To Order

Transparent PET Membrane Cell Insert, Non-treated (1 Pcs/Pack, 10 Pcs/Case)

Cat.No.	Well	Pore Size (um)	Membrane Density	Insert Membrane Growth Area(cm ²)	Insert Diameter (mm)	Well Volume (ml)	Insert Volume (ml)	Insert Number
723131 ▲	6	0.4	1 x 10 ⁸ well/cm ²	4.67	24	2.6	1.5	6
724131 ▲	12	0.4	1 x 10 ⁸ well/cm ²	1.12	12	1.5	0.5	12
725131 ▲	24	0.4	1 x 10 ⁸ well/cm ²	0.33	6.5	0.6	0.1	12
723031 ▲	6	3	2 x 10 ⁶ well/cm ²	4.67	24	2.6	1.5	6
724031 ▲	12	3	2 x 10 ⁶ well/cm ²	1.12	12	1.5	0.5	12
725031 ▲	24	3	2 x 10 ⁶ well/cm ²	0.33	6.5	0.6	0.1	12

▲ Make To Order

EDGE Plates New

Feature

Unique Design to minimize Edge Effect during cell culturing process.

Tips

- Adding proper media into the edge.
- Careful to handle to avoid spill into culturing wells.

Cat.No.	Well	TC	/Pack	/Case
714011	6	Yes	1	50
713011	96	Yes	1	100
714001	6	No	1	50
713001	96	No	1	100

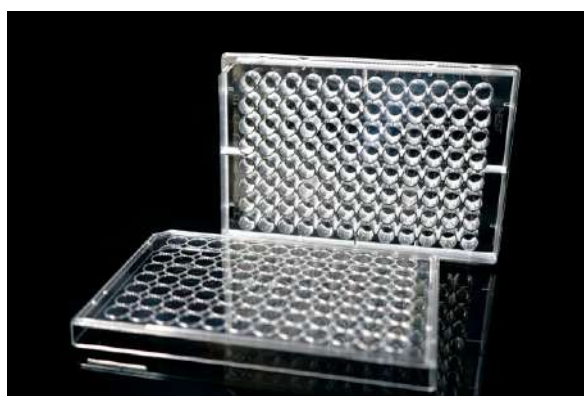
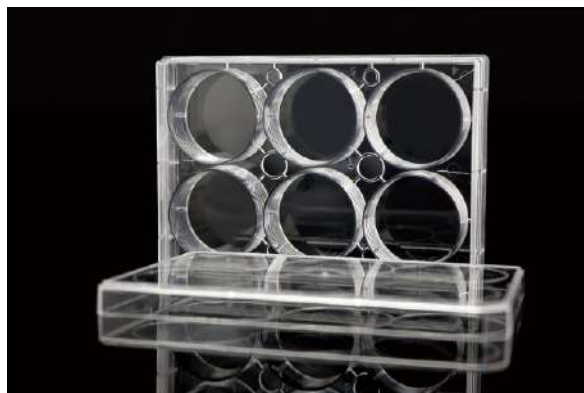

Cover Glasses

Feature

- High quality glass, non-cytotoxic
- Sterile, non-treated
- Manufactured in 100,000 grade clean room
- Resistance to organic solvent
- Autoclavable
- Can be used in confocal experiment



Cat.No.	Glass Diameter (mm)	Thickness (mm)	/Pack	Application
801010	14	0.17	100	24 Well Cell Culture Plate
801007	15	0.17	100	24 Well Cell Culture Plate
801011	18	0.17	100	12 Well Cell Culture Plate
801008	20	0.17	100	12 Well Cell Culture Plate
801009	25	0.17	100	6 Well Cell Culture Plate

Glass Bottom Cell Culture Dishes / Plates

Feature

- Can be used for live cells observation
- Special bottom design for easy grip
- Round cover glass insert for good appearance
- Medical adhesive glue to guarantee non-cytotoxicity
- Sterilized by E-beam, SAL=10⁻⁶
- USP VI Polypropylene
- High quality cover glass of standard thickness 0.16-0.19 mm



Glass Bottom Culture Dishes

Cat.No.	Type (mm)	Glass Diameter (mm)	Cultivation Area (cm ²)	TC	/Pack	/Case
801002	35	15	6.2	Yes	10	200
801001	35	20	6.2	Yes	10	200



Glass Bottom Culture Plates

Cat.No.	Spec	Glass Diameter (mm)	Cultivation Area (cm ²)	TC	/Case
801004	6	34.8	9.5	Yes	10
801006	24	15.6	1.9	Yes	10

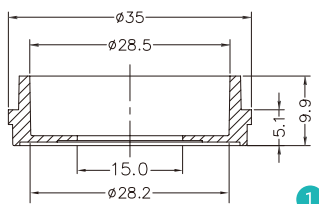

1

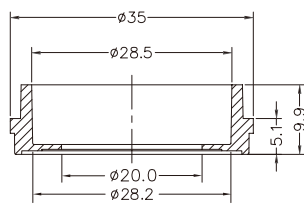

2

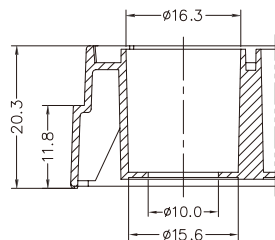

3

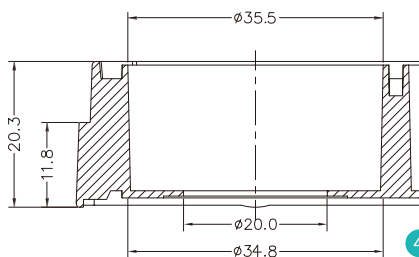

4

Unit: mm

- ① Ø15 Glass bottom dish
- ② Ø20 Glass bottom dish
- ③ 24 Bottom plate
- ④ 6 Bottom plate

Cell Culture Dishes

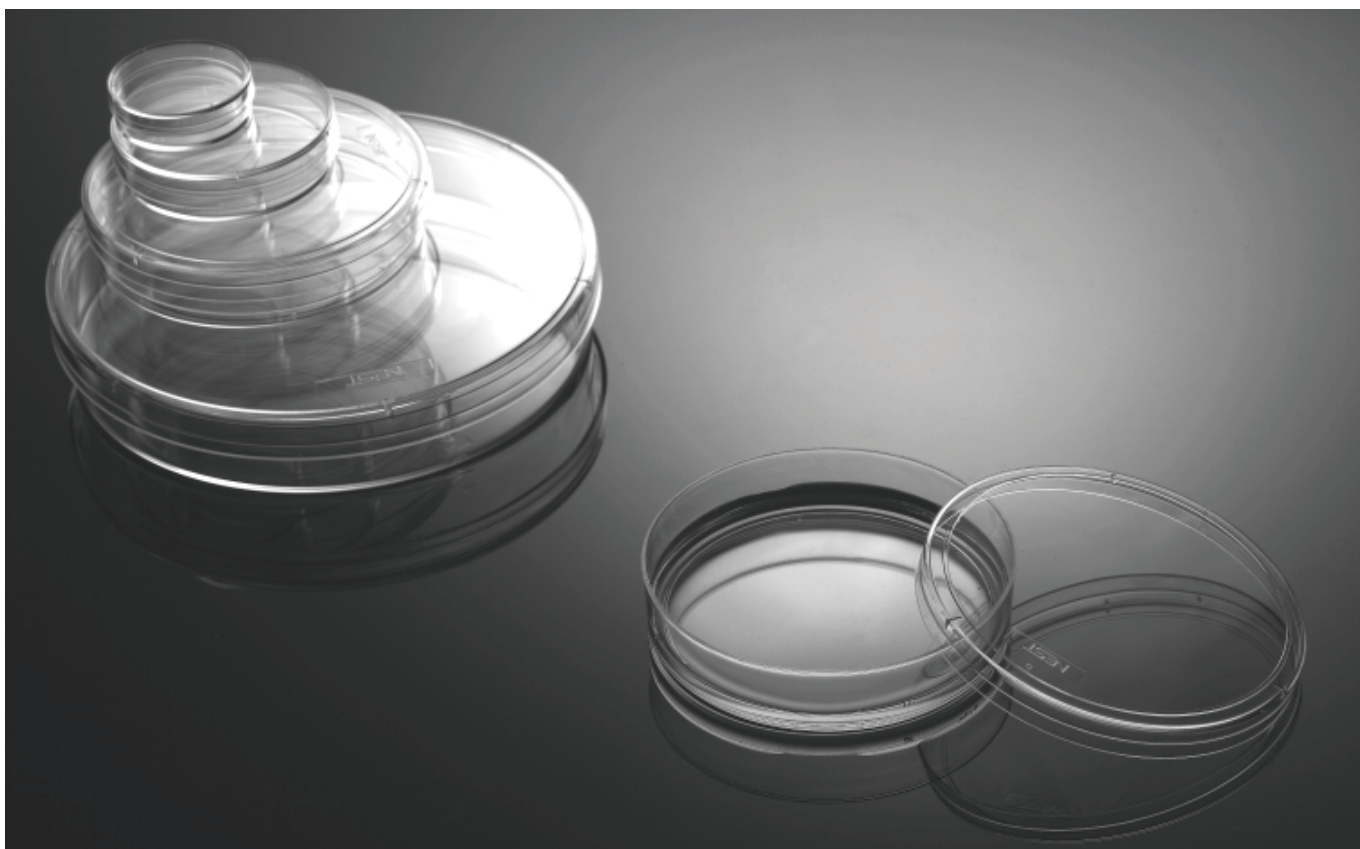

Cat.No.	Spec(mm)			Cell Growth Area (cm ²)	Recommended Medium Volume (mL)	/Pack	/Case
	Type	Height	Diameter				
706001	35	12	33.6	8.5	1.8-2.7	20	500
New 706201	35(With Gripping Ring)	12	33.6	8.5	1.8~2.7	20	500
705001	60	15	55.2	22.9	4.2-6.3	20	500
704004	100	20	87.2	57.6	11-16.5	5	300
704002	100	20	87.2	57.6	11-16.5	10	300
704001	100	20	87.2	57.6	11-16.5	20	300
704202	100(With Gripping Ring)	20	86.9	59.3	11-16.5	10	300
704201	100(With Gripping Ring)	20	86.9	59.3	11-16.5	20	300
715001	150	25	139.9	150.1	30.4-45.6	5	100

Cell Culture Flasks

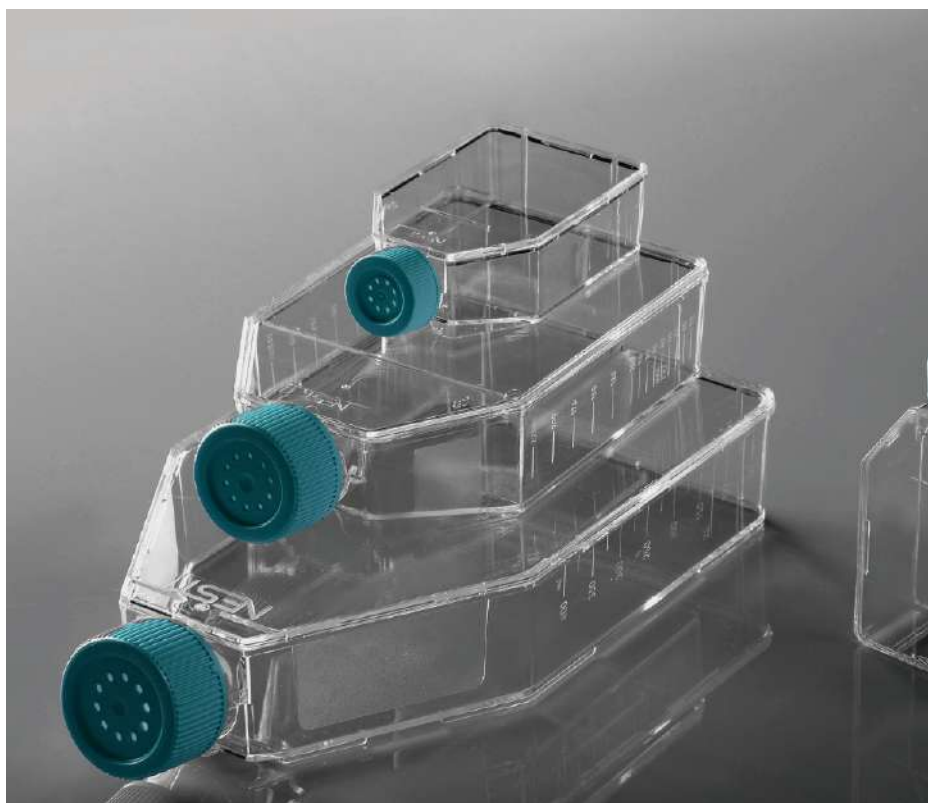

Feature

- Packaged in zip bags
- High clarity, 100% virgin polystyrene
- Frosted writing and clear graduations
- Stackable, sterilized by E-Beam
- Clear lot number for batch traceability
- Non-Pyrogenic, DNase/RNase free



Tissue Culture Treated Cell Culture Flasks

Cat.No.	Cell Growth Area (cm ²)	Cap Style	Volume (mL)	Recommended Medium Volume(mL)	/Pack	/Case
707001	25	Plug Seal	50	5-7.5	10	200
707003	25	Vent	50	5-7.5	10	200
708001	75	Plug Seal	250	15-22.5	5	100
708003	75	Vent	250	15-22.5	5	100
709001	175	Plug Seal	750	35-52.5	5	40
709003	175	Vent	750	35-52.5	5	40
721001	225	Plug Seal	950	45-67.5	5	25
721003	225	Vent	950	45-67.5	5	25

Non-treated Cell Culture Flasks

Cat.No.	Cell Growth Area (cm ²)	Cap Style	Volume (mL)	Recommended Medium Volume(mL)	/Pack	/Case
707011	25	Plug Seal	50	5-7.5	10	200
707013	25	Vent	50	5-7.5	10	200
708011	75	Plug Seal	250	15-22.5	5	100
708013	75	Vent	250	15-22.5	5	100
709011	175	Plug Seal	750	35-52.5	5	40
709013	175	Vent	750	35-52.5	5	40
721011	225	Plug Seal	950	45-67.5	5	25
721013	225	Vent	950	45-67.5	5	25

Cell Scrapers

Feature

- Free rotating blade, make the blade twist to right direction
- Non-pyrogenic and DNase/RNase free

Cat.No.	Spec(mm)		Sterilization	/Case
	Total Length	Blade Width		
710001	220	13	Yes	100
710011	280	20	Yes	100

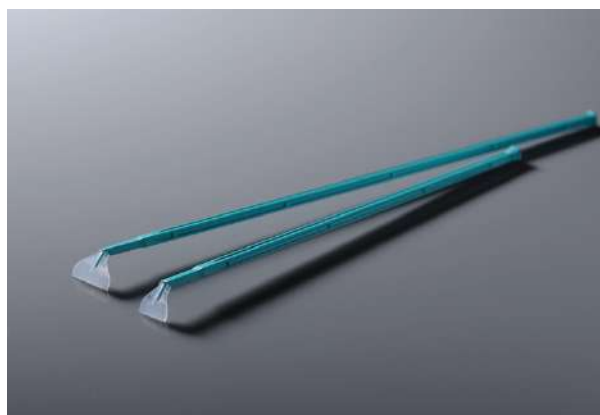

5-Layer Cell Culture Flasks

Feature

- High clarity medical grade polystyrene material
- Growth area: 870cm²
- Sterilized by E-Beam, non-pyrogenic

Cat.No.	Cap Style	Recommended Medium Volume(mL)	TC	/Pack	/Case
731001	Plug Seal Cap	100-150	Yes	1	8
731002	Vent Cap	100-150	Yes	1	8



Guidelines For Use:

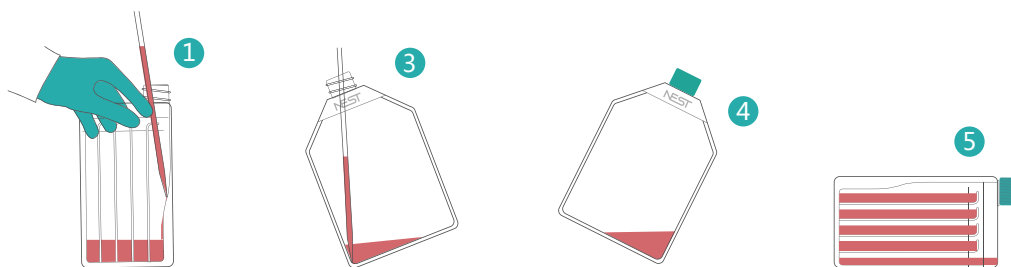

1. Mix cell suspension with medium: Prepare cell suspension of required concentration in a container. Recommended volume is about 30- 50mL per layer.
2. Add the mixed liquid into the Multi-layer Flask slowly with serological pipettes. To avoid foams and bubbles, allow liquid stream to flow along the slope of the Multi-layer Flask. (Save a little liquid in pipette each time.)
3. Tips: A 10mL pipette allows media to be dispensed at the bottom of the vessel. A 25mL pipette allows media to be dispensed just past the NEST Logo.
4. Hold the Multi-layer Flask upright with the Logo facing you and tilt clockwise to a 45° angle on a flat work surface to partition the liquid into each layer.
5. While holding the Multi-layer Flask at a 45° angle, gently lay it flat onto the work surface with logo facing up.
6. After placing the Multi-layer Flask flat on a work surface, gently rock back and forth and side-to-side to distribute cells evenly onto culture surfaces.
7. Tips: Take care to avoid foaming of medium, and not to spill liquid from each layer.
8. Repeat Step 3 to put the flask quickly and slightly into the incubator. Then, lay it flat as shown in Step 4. You may choose to either aspirate or pour the media from Multi-layer Flask.
9. Aspirating method: To aspirate or remove media, tilt Multi-layer Flask, with the NEST Logo facing you, counter-clock wise to a 45° angle while inverting the Multi-Flask toward you. Then, tilt Multi-layer Flask to the right, continuing to aspirate all residual media.
10. Pouring method: With Logo facing you, pour spent media from Multi-layer Flask
11. Tips: Aspirate media using a NEST 2mL or 10mL aspirating pipette.
12. Wash with buffer for one time and add dissociating reagent (≥5mL per layer). Then, follow Steps 3-4 to distribute to dissociating reagent to each layer.
13. Neutralize with inactivating solution and mix following Steps 3-4. Gently swirl to dislodge cells completely.
14. Follow Step 7 "Aspirating Method" protocol and collect cell suspension using a NEST 10mL serological pipette.
15. Follow Step 8 "Pouring Method". Pour the cell suspension into a NEST conical tube.
16. Rinse with additional wash buffer if needed.
17. Search "NEST Multi-layer Flask" video on NEST website or Youtube.

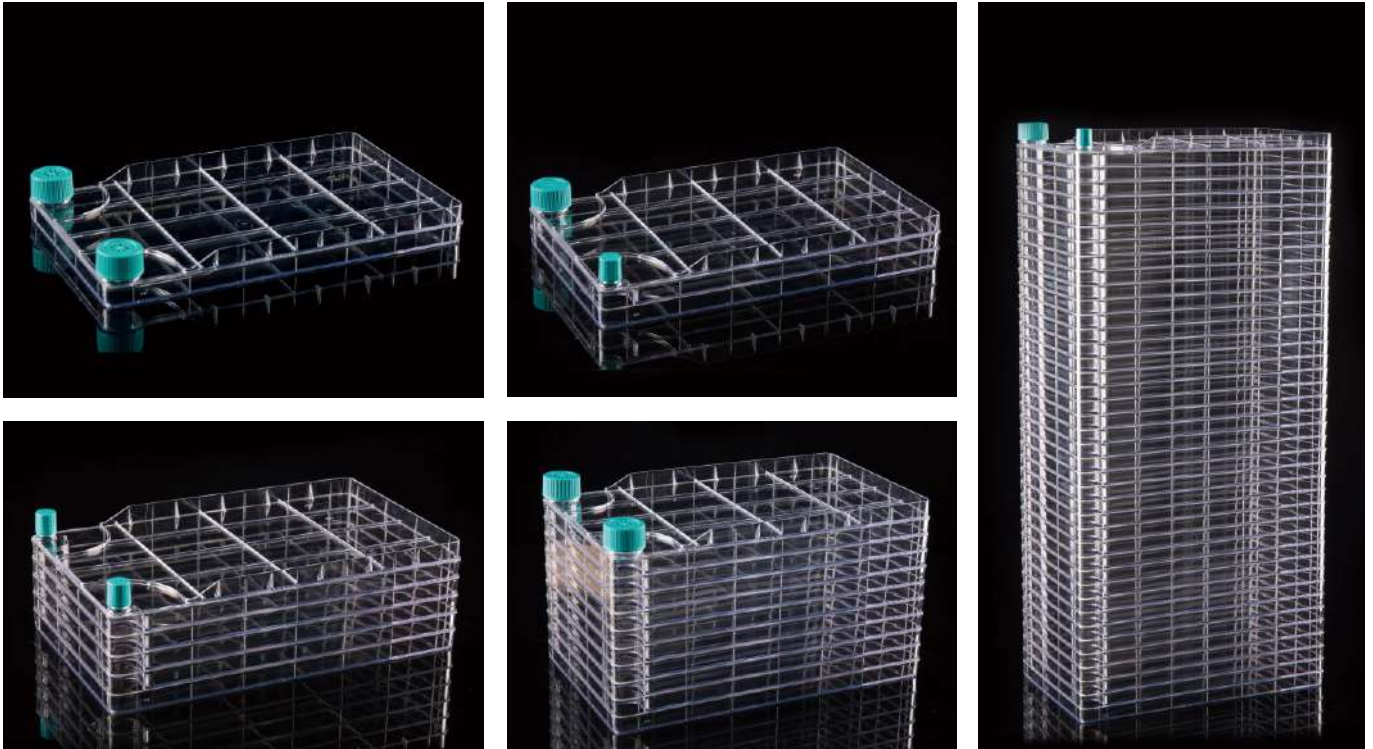

Double Wide Mouth, Filter Vent Caps

Cat.No.	Layer	Cultivation area (cm ²)	Length (mm)	Width (mm)	Height (mm)	/Case
771001	1	647	335	205	44	8
771101	2	1,279	335	205	61	8
771204	5	3,175	335	205	112	4
771302	10	6,335	335	205	197	6
771403	40	25,295	335	205	712	2

Double Narrow Mouth, (One Filter Vent Cap & One Plug Seal Cap)

Cat.No.	Layer	Cultivation area (cm ²)	Length (mm)	Width (mm)	Height (mm)	/Case
772001	1	647	335	205	44	8
772101	2	1,279	335	205	61	8
772204	5	3,175	335	205	112	4
772302	10	6,335	335	205	197	6
772403	40	25,295	335	205	712	2

One Wide Mouth Filter Vent Cap & One Narrow Mouth Plug Seal Cap

Cat.No.	Layer	Cultivation area (cm ²)	Length (mm)	Width (mm)	Height (mm)	/Case
773001	1	647	335	205	44	8
773101	2	1,279	335	205	61	8
773204	5	3,175	335	205	112	4
773302	10	6,335	335	205	197	6
773403	40	25,295	335	205	712	2

- Large mouth design for easy pouring of the medium directly;
- The small mouth design for easy connection with the feeding systems;
- Breathable cover: 0.22um hydrophobic gas permeable membrane, hindering bacteria and water, can also avoid liquid swelling.

Feature

NEST BioFactory™ has been widely used in large-scale culture of cell lines such as VERO, MRC-5, 2BS, 293T, L-929, MSE and MSC.

- Made of Virgin Polystyrene, which meets USP Class VI requirements for plastic containers and closures;
- Manufactured in dedicated 10,000-class clean room following GMP standards to ensure product quality and stability;
- Ultrasonic welding process without any chemical addition;
- Surface TC treatment ensures efficient cell attachment;
- In-house E-beam sterilization meets the ISO13485 and ISO 11137:2006 standards and achieves sterility level SAL = 10^{-6} ;
- Independent double-layer sterile packaging;
- Compatible with Corning® CellSTACK® Culture Chamber accessories.

Guidelines for use Cell culture



Pour the prepared suspension into the BioFactory™ (recommended volume of 150-200 ml per layer).



Turn the BioFactory™ Chamber 90° to keep the liquid level at the level.



Turn the BioFactory™ Chamber 90° so that the filling and venting ports are up (as shown). It is normal for the medium level in the bottom chamber section to be slightly higher.



Gently lower the BioFactory™ Chamber to its normal horizontal incubation position and gently tilt the chamber back and forth until the surface of each chamber is completely covered with medium.



Put the BioFactory™ into the incubator.

Guidelines for use Precautions

1. Continued mixing of the cell suspension (gently as to not create foam) when filling chambers is recommended to ensure even cell distribution. Preheating the medium to incubation temperature is also recommended to ensure rapid cell attachment. For larger BioFactory™ Chambers, prewarming the Chamber and the medium is especially important due to the increased time required for the middle chambers to reach desired incubation temperatures.
2. Be careful not to spray the hydrophobic filters on the venting caps with alcohol as this will wet them and potentially block the gas flow resulting in pressure build-up or preventing gas exchange.

Cell harvest

For enzymatic cell harvesting using trypsin or other dissociating enzymes, NEST recommends washing the chamber with calcium and magnesium-free phosphate buffered saline (40 to 50 mL per chamber) at least once to remove any serum containing medium residues. Then add prewarmed dissociating solution (20 to 30 mL per chamber) to the chamber and carefully tilt the chamber back and forth and side to side to ensure the entire cell surface is completely wetted with dissociating solution.

Precaution

Although a 1°C ~ 2°C temperature variation is common for most cell culture rooms or hoods, it may decrease the yields significantly. Please monitor the temperatures for the BioFactories carefully.

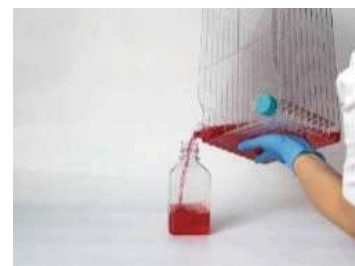

Accessories



Cat.No.	Name	Material	/Pack	/Case
740001	Wide Mouth Seal cap for BioFactory	HDPE	1	10
740011	Wide Mouth Vent cap for BioFactory	HDPE	1	10
740101	Narrow Mouth Seal cap for BioFactory	HDPE	1	10
740111	Narrow Mouth Vent cap for BioFactory	HDPE	1	10

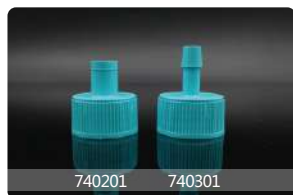

Cat.No.	Name	Material	spec(mm)		/Pack	/Case
			The inside diameter	The outside diameter		
740201	Adaptor Cap Wide Mouth to Narrow Mouth	HDPE	11.8	14.3	1	10
740301	Adaptor Cap Wide Mouth to 3/8 Inches(9.5 mm)hose	HDPE	7.3	11.4	1	10



744001 SPT-50 hose

Inner Dia# 3/8 Inches (9.5 mm) ,
Out Dia# 5/8 Inches (15.9 mm) ,
50 Inches/ 15 meters
1 pcs / pack



746001 C-Flex welding hose

Inner Dia# 3/8 Inches (9.5 mm) ,
Out Dia# 5/8 Inches (15.9 mm) ,
50 Inches/ 15 meters
1 pcs / pack



742001 Vent Filter

0.22 um , 50 mm diameter
1 pcs / pack



747001 CPC Connector

CPC & PC
(Inner Dia #3/8) for hose to hose connecting
1 pcs / pack



743001 Hose clamp

Hose clamp for 12-18 mm
diameter hose
1 pcs / pack



751001 Y Shape CPC Connector

Y Shape CPC Connector for Inner Dia
#3/8 Hose
1 pcs / pack



750001 Funnel for Wide Mouth

Upper Dia 60mm, Lower Dia 24mm
1 pcs / pack



749001 T Shape CPC Connector

T Shape CPC Connector for Inner Dia
#3/8 Hose
1 pcs / pack



741001 Adaptor connector

Adaptor connector to 3/8 Inches
(9.5 mm)hose
1 pcs / pack

745001 Combination packages

Each set contains:

- 740201 Vent Filter/ 1
- 740301 Adaptor Cap Wide Mouth to 3/8 Inches (9.5 mm) hose/1
- 743001 Hose clamp for 12-18 mm diameter hose/1
- 741001 Adaptor connector to 3/8 Inches (9.5 mm) hose/1
- 742001 Vent Filter/1
- 744001 SPT-50 hose

Mini Bioreactors New



Feature

- USP VI Polypropylene Tubes
- HDPE Caps
- High transparency, easy to observe
- Vent caps with 0.22um hydrophobic filters for gas exchange without contamination.
- Packaged in sterile, zip-sealable bags
- Non-pyrogenic, Non-cytotoxic
- DNase/Rnase-free
- Can be used for centrifugation.

Cat.No.	Volume (mL)	/Pack	/Case
788211	50	10	100

PETG Erlenmeyer Flasks

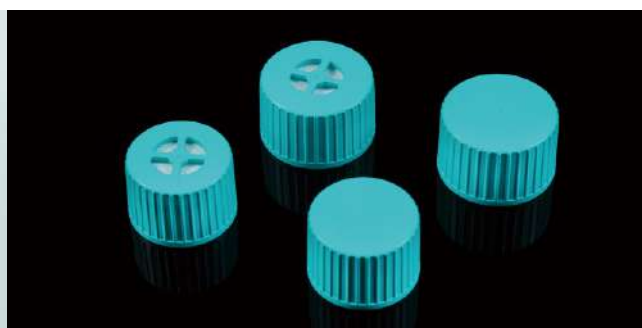

Feature

- PETG Bottle & HDPE Cap
- Sterilized by E-Beam, Nonpyrogenic
- Individually wrapped in sterile bags

Cat.No.	Volume (mL)	Cap Style	Size(mm)			/Case
			Height	Bottleneck Diameter	Bottom Diameter	
781001	125	Plug Seal	106.8	34	66	24
781011	125	Vent	106.8	34	66	24
782001	250	Plug Seal	137.8	34	83	12
782011	250	Vent	137.8	34	83	12
783001	500	Plug Seal	175.8	39	101	12
783011	500	Vent	175.8	39	101	12
784001	1000	Plug Seal	213.3	39	127	6
784011	1000	Vent	213.3	39	127	6

PC Erlenmeyer Flasks New



Feature

- PC Bottle & HDPE Cap
- Vent caps with 0.2um hydrophobic filters for gas exchange without contamination.
- Sterilized by E-Beam
- Nonpyrogenic

Cat.No.	Volume (L)	Cap Style	Size(mm)			/Case
			Height	Bottleneck Diameter	Bottom Diameter	
785001	2	Plug Seal	285	47	162	6
785011	2	Vent	285	47	162	6
786001	3	Plug Seal	253	62	230	4
786011	3	Vent	253	62	230	4
787001	5	Plug Seal	285	90	230	4
787011	5	Vent	285	90	230	4

3D Barcode Cryogenic Vial

New

Cat.No.	Volume (ml)	Cap Style	/Rack	Rack/Cs
627102	1.8	External Thread, Double Secure Cap	10*10	12
627002	1.8	External Thread	10*10	12



Cryogenic Vials



Feature

- USP VI Polypropylene Tubes, HDPE Caps
- Round Bottom, Self-standing
- Solid, one-piece construction ensures the barcode not fall off during the storage under low temperature
- Autoclavable
- Clear graduations and white marking area
- Sterilized by E-Beam
- Non-pyrogenic, DNase/RNase and human DNA free
- Recommend to store in gas phase of the nitrogen tank
- External thread Cap: Special screw cap designed without silicone ring to avoid the contamination risk.
- Internal thread Cap: Special screw cap designed with silicone O-ring to secure the sealing under various condition.

Cryogenic Vial, Bulk Package

Cat.No.	Volume (mL)	Cap Style	Packaging	
			/Pack	/Case
618001	0.5	External thread	50	2,000
606001	1.2	External thread	50	2,000
607001	2.0	External thread	50	2,000
624001	3.0	External thread	50	1,000
608001	4.0	External thread	50	1,000
609001	5.0	External thread	50	1,000
618101	0.5	Internal thread	50	2,000
606101	1.2	Internal thread	50	2,000
607101	2.0	Internal thread	50	2,000
624101	3.0	Internal thread	50	1,000
608101	4.0	Internal thread	50	1,000
609101	5.0	Internal thread	50	1,000

Cryogenic Vial, Racked Package

Cat.No.	Volume (mL)	Cap Style	/Rack	Rack/Cs
618102	0.5	Internal thread	10*10	16
606102	1.2	Internal thread	10*10	14
607102	2.0	Internal thread	10*10	12
618003	0.5	External thread	9*9	16
606003	1.2	External thread	9*9	14
607003	2.0	External thread	9*9	12
624003	3.0	External thread	9*9	8
608003	4.0	External thread	9*9	8
609003	5.0	External thread	9*9	6
618103	0.5	Internal thread	9*9	16
606103	1.2	Internal thread	9*9	14
607103	2.0	Internal thread	9*9	12
624103	3.0	Internal thread	9*9	8
608103	4.0	Internal thread	9*9	8
609103	5.0	Internal thread	9*9	6

Cryogenic 2D Matrix Vials

Feature

- Autoclavable
- Sterilized by E-Beam
- Non-pyrogenic, DNase/RNase free
- Recommend to store in gas phase of the nitrogen tank



2D Barcode Cryogenic Vials, Bulk Package

Cat. No.	Volume(mL)	Cap Style	/Pack	/Case
618041	0.5	External Thread	50	2,000
606041	1.2	External Thread	50	2,000
607041	2.0	External Thread	50	2,000
624041	3.0	External Thread	50	1,000
608041	4.0	External Thread	50	1,000
609041	5.0	External Thread	50	1,000
618141	0.5	Internal Thread	50	2,000
606141	1.2	Internal Thread	50	2,000
607141	2.0	Internal Thread	50	2,000
624141	3.0	Internal Thread	50	1,000
608141	4.0	Internal Thread	50	1,000
609141	5.0	Internal Thread	50	1,000

2D Barcode Cryogenic Vials, Racked Package

Cat. No.	Volume(mL)	Cap Style	/Rack	Rack/Cs
618152	0.5	Internal Thread	10*10	16
606152	1.2	Internal Thread	10*10	14
607152	2.0	Internal Thread	10*10	12
618053	0.5	External Thread	9*9	16
606053	1.2	External Thread	9*9	14
607053	2.0	External Thread	9*9	12
624053	3.0	External Thread	9*9	8
608053	4.0	External Thread	9*9	8
609053	5.0	External Thread	9*9	6
618153	0.5	Internal Thread	9*9	16
606153	1.2	Internal Thread	9*9	14
607153	2.0	Internal Thread	9*9	12
624153	3.0	Internal Thread	9*9	8
608153	4.0	Internal Thread	9*9	8
609153	5.0	Internal Thread	9*9	6

Colored Inserts

Cat. No.	Color	/Pack	/Case
611001	White	100	1,000
611002	Red	100	1,000
611003	Yellow	100	1,000
611004	Blue	100	1,000
611005	Green	100	1,000
611006	Purple	100	1,000



Cryo Boxes

Feature

- Temperature range: -196 °C to +70 °C
- Individual package
- Each box includes drain holes and air vents to minimize condensation.

Cat. No.	Description	Spec	/Case
616204	For 0.5ml vials, Internal Thread Cryogenic Vial Only	10*10	56
616305	For 1.2ml vials, Internal Thread Cryogenic Vial Only	10*10	48
616001	For 2.0ml vials, Internal Thread Cryogenic Vial Only	10*10	40
616224	For 0.5 ml vials	9*9	56
616325	For 1.2 ml vials	9*9	48
616021	For 2.0 ml vials	9*9	40
616421	For 3.0 ml vials	9*9	32
616121	For 4.0 ml vials	9*9	32
616521	For 5.0 ml vials	9*9	32
616031	For Cat.No. 627102 & 627002	10*10	40

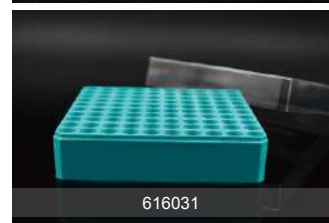
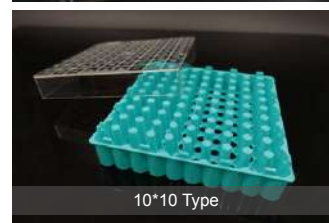
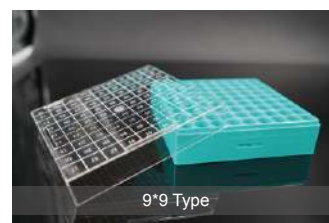

Ice Free Cool Box

New

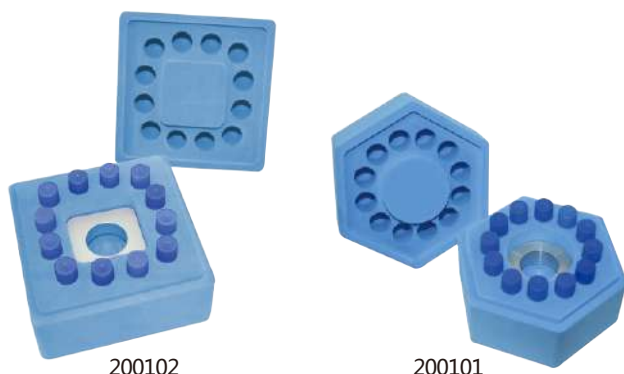

Cat.No.	Specification (mm)	Weight (g)
200101	S108 x 100 (S: Side Length)	120
200102	117*117*100	160

Application:

Holds 12 - 1ml / 2ml cryogenic vials or 1.5ml / 2ml centrifuge tubes.

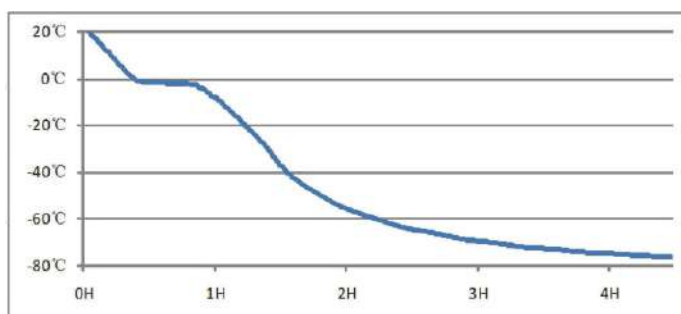

Ice Free Cool Box

New

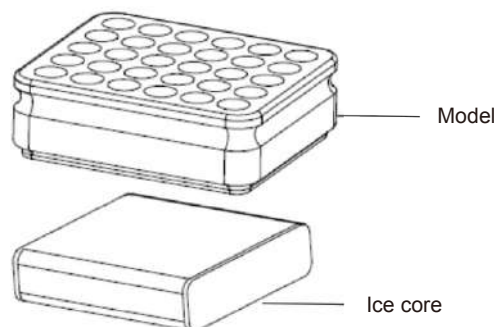

Cat.No.	Specification (mm)	Weight (g)	Application
200103	152x170x123	1,300	200902 & 200904 included in standard packaging (1 each)
200901	152x170x123	140	Don't include ice core & tube module

Technical Parameters

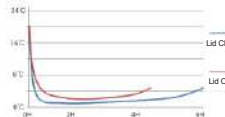
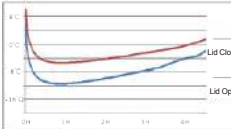
Temperature Range	Cooling Sources	Cooling Sources Processing	Module Processing	Insulation Time (Open cover)	Insulation Time (Close cover)	Performance Diagram
0.5°C~4°C	Ice core CL	Place it above 4hrs under -20 ℃ , use after 10mins when room temp. goes up.	Precooling to 0.5°C~4°C	4h	6h	
0.5°C~4°C		Place it above 4hrs under -20 ℃ , then use directly.	Room Temp			
0.5°C~4°C		Place it above 2hrs under -80 ℃ , then use directly.				
-18°C~-4°C	Ice core CF	Place it above 6hrs under -20 ℃ .	Precooling 30mins under -20°C	3h	4h	
-18°C~-4°C		Place it above 3hrs under -80 ℃ .				

Ice Core

Cat.No.	Name	Temperature Range	Refrigerator's Temperature	Freeze Time	Specifications (mm)
200902	Cooling Core	0.5°C~4°C	-20°C	4h+	105 x 100 x 26
		0.5°C~4°C	-80°C	2h+	105 x 100 x 26
200903	Freeze Core	-18°C~4°C	-20°C	6h+	105 x 100 x 26
		-18°C~4°C	-80°C	3h+	105 x 100 x 26

Tube Module

Cat.No.	Name	Specifications (mm)	Application
200904	2ml Module	119 x 101 x 38	30 x 2 ml Cryo Tube (30-φ12.6)
200905	1.5ml Module	119 x 101 x 38	48 x 1.5 ml Cryo Tube (48-φ11)
200906	5ml Module	119 x 101 x 38	/
200907	PCR Module	119 x 101 x 38	Match with PCR Module (96-φ7)

Square shape PET Media Bottles New

Feature

- Clear scale
- Sterilized by E-beam
- PET bottle with transparency equivalent to glass

Cat.No.	Volume (mL)	Size(mm)		/Pack	/Case
		Bottleneck Diameter	Height		
333001	500	34	170	8	24
334001	1000	34	215	4	12



Round Storage Bottles New

Feature

- DNase/RNase free, Sterilized by E-beam
- PP material can autoclavable in 121 °C
- These amber bottles are ideal for storing light-sensitive samples.

Cat.No.	Volume (mL)	Material	/Pack	/Case
335201	8	PP	20	400
336201	15	PP	20	400
337201	30	PP	10	200
338201	60	PP	10	200
339201	125	PP	10	100
340201	250	PP	10	100
341201	500	PP	10	50



Feature

- DNase/RNase free, Sterilized by E-beam
- HDPE material can be used in freezer down to -80 °C

Cat.No.	Volume (mL)	Material	/Pack	/Case
335101	8	HDPE	20	400
336101	15	HDPE	20	400
337101	30	HDPE	10	200
338101	60	HDPE	10	200
339101	125	HDPE	10	100
340101	250	HDPE	10	100
341101	500	HDPE	10	50



Vacuum Filtration Systems New



Cat. No.	Membrane	Volume (ml)	/Case
330011	PES	250	12
330111	PES	500	12
330001	PVDF	250	12
330101	PVDF	500	12
330021	MCE	250	12
330121	MCE	500	12
330031	CA	250	12
330131	CA	500	12
330112	PES (Up Cup)	500	12
330102	PVDF (Up Cup)	500	12

Pore Density: 0.22um

Membrane selection guide

Membrane	Wettability	Chemical Compatibility	PH Stability	Protein Binding	Sample Application
MCE	Hydrophilic	Poor	4-8	Very Low	Biological fluids, microbiology particle analysis and air monitoring
PES	Hydrophilic	Poor	3-12	Low	Tissue culture media, environmental analysis
PVDF	Hydrophilic	Very Good	3-8	Low	HPLC solution and general biological samples
CA	Hydrophilic	Good	4-8	Low	HPLC solution, media, serum and buffer solutions

Syrings Filters New



Feature

- Nonpyrogenic and noncytotoxic
- Sterilized by E-beam
- Individually Wrapped

Cat. No.	Membrane	Size (mm)	Pore Density (um)	/Pack	/Case
331011	PES	30	0.22	100	1,000
331001	PVDF	30	0.22	100	1,000

Centrifuge Tubes



Feature

- Meet the requirements of analytical level
- High strength non-toxic materials, raw material comply with USP VI requirements
- Printed clear graduations with marking area
- PP for the tube and HDPE for the cap
- One-hand operation design
- Sterilized by E-Beam
- DNase, RNase and pyrogen free

Centrifuge Tubes, Premium

- Meet the requirements of analytical level
- High strength non-toxic materials
- Raw material comply with USP VI requirements

Cat.No.	Volume (mL)	Color	Max.RCF(xg)	Type	Packaging	/Pack	/Case
601001	15	Clear	12,000	Premium	PS Rack	50	500
601002	15	Clear	12,000	Premium	Bulk	50	500
602001	50	Clear	12,000	Premium	PS Rack	25	500
602002	50	Clear	12,000	Premium	Bulk	25	500
601201 ▲	15	Amber	12,000	Premium	PS Rack	50	500
602201 ▲	50	Amber	12,000	Premium	PS Rack	25	500



▲ Make To Order

Cell Strainers

Cat.No.	Spec (um)	Color	Sterile	/Case
258369	40	Blue	Yes	50
258368	70	White	Yes	50
258367	100	Yellow	Yes	50



Centrifuge Tubes



Centrifuge Tubes, Standard & Self-standing

- Made from virgin polypropylene to meet the general requirements of the laboratory
- Made from virgin polypropylene, skirted and self-standing

Cat.No.	Volume(mL)	Max.RCF(xg)	Packaging	Type	/Pack	/Case
601051	15	12,000	PS Rack	Standard	50	500
601052	15	12,000	Bulk	Standard	50	500
602051	50	12,000	PS Rack	Standard	25	500
602052	50	12,000	Bulk	Standard	25	500
602072	50 (Self-Standing)	5,000	Bulk	Standard	25	500



Centrifuge Tube Racks



Feature

- Made from virgin polypropylene
- Reusable and economic
- Non-sterilized

Cat.No.	Application	/Case
610001	For 15mL tubes	50
610101	For 50mL tubes	50

Microcentrifuge Tubes



Feature

- USP VI grade polypropylene material, free from heavy metal
- RCF: 30000 xg
- Special safelock cap design provides secure lid sealing
- Clear graduations and frosted marking area
- Easy opening and closing
- Autoclavable
- DNase/RNase free, endotoxin level less than 0.1EU
- Both sterile and non-sterile tubes are available

Cat.No.	Volume (mL)	Bottom	Sterile	/Pack	/Case
605001	0.6	Conical	NO	1,000	10,000
615001	1.5	Conical	NO	500	5,000
620011	2	Round	NO	500	5,000
605601	0.6	Conical	YES	50	7,500
615601	1.5	Conical	YES	50	4,000
620611	2	Round	YES	50	4,000

Amber Microcentrifuge Tubes New

Cat.No.	Volume (mL)	Max. RCF (xg)	Sterile	/Pack	/Case
615401 ▲	1.5	30,000	YES	50	4,000
605401 ▲	0.6	30,000	YES	50	7,500

▲ Make To Order

Micro Tube Boxes

Feature

- Clear polycarbonate cover for easy identification
- Temperature range from -80 °C -121 °C
- Solid polypropylene base and polycarbonate cover
- Non-sterilized

Cat.No.	Application	Spec (well)	/Pack	/Case
613001	0.6	10*10	1	40
613111	1.5/2	8*8	1	40



5 mL Centrifuge Tubes New



Cat.No.	Volume (mL)	Sterile	/Pack	/Case
603011 ▲	5	NO	200	2,000
603111 ▲	5	YES	200	2,000

▲ Make To Order

Screw Cap Tubes New



Cat.No.	Volume (mL)	Bottom	Cap Style	/Pack	/Case
633001	0.5ml	Self-Standing	External Thread, with Sealing ring	1,000	10,000
633011	0.5ml	Self-Standing	External Thread, Hinged Cap with Sealing ring	1,000	10,000
634001	1.5ml	Self-Standing	External Thread, with Sealing ring	1,000	10,000
634011	1.5ml	Self-Standing	External Thread, Hinged Cap with Sealing ring	1,000	10,000
635001	2.0ml	Self-Standing	External Thread, with Sealing ring	1,000	10,000
634111	1.5ml	Conical	External Thread, Hinged Cap with Sealing ring	1,000	10,000
634101	1.5ml	Conical	External Thread, with Sealing ring	1,000	10,000

Pipette Tips



Pipette Tips, Bulk

Cat.No.	Volume (uL)	Color	Pack	Sterile	/Pack	/Case
301006	10	Clear	Bulk	No	1,000	20,000
302106	200	Yellow	Bulk	No	1,000	20,000
305006	300	Clear	Bulk	No	1,000	10,000
303206	1,000	Blue	Bulk	No	1,000	5,000
304006	1,250	Clear	Bulk	No	500	5,000

Pipette Tips, Box

Cat.No.	Volume (uL)	Color	Pack	Sterile	/Pack	/Case
301016	10	Clear	Box	Yes	96	4,800
302116	200	Yellow	Box	Yes	96	4,800
305016	300	Clear	Box	Yes	96	4,800
303216	1,000	Blue	Box	Yes	100	5,000
304016	1,250	Clear	Box	Yes	96	4,800

Filter Tips, Bulk

Cat.No.	Volume (uL)	Color	Pack	Sterile	/Pack	/Case
311001	10	Clear	Bulk	No	1,000	10,000
316001	100	Clear	Bulk	No	1,000	10,000
312001	200	Clear	Bulk	No	1,000	10,000
313001	1,000	Clear	Bulk	No	500	5,000

Pipette Tips



Filter Tips, Box

Cat.No.	Volume (uL)	Color	Pack	Sterile	/Pack	/Case
311012	10	Clear	Box	Yes	96	4,800
316012	100	Clear	Box	Yes	96	4,800
312012	200	Clear	Box	Yes	96	4,800
313012	1,000	Clear	Box	Yes	96	4,800



Automation Tips New

Cat.No.	Volume (uL)	Pack	Sterile	/Pack	/Case
332001	50	Box	Yes	96	4,800
332101	200	Box	Yes	96	4,800
332201	1,000	Box	Yes	96	4,800

Adapter type: Tecan Genesis/Freedom/Evo/Tecan MiniPrep/Tecan Cattro

Pasteur Pipettes



Cat.No.	Volume (mL)	Length (mm)	Pack	Sterile	/Box	/Case
318012	1	160	Individually Packed	YES	500	2,000
318112	2	150	Individually Packed	YES	500	2,000
318212	3	162	Individually Packed	YES	500	2,000
318314	3	182	Individually Packed	YES	200	2,000
318031	1	160	Bulk	NO	500	5,000
318131	2	150	Bulk	NO	500	5,000
318231	3	162	Bulk	NO	500	5,000

Serological Pipettes



Cat.No.	Volume (mL)	Description	/Pack	/Case
324001	1	Individually Wrapped	500	3,000
325001	2	Individually Wrapped	400	2,400
325011	2	Individually Wrapped	200	800
326001	5	Individually Wrapped	200	800
327001	10	3 pieces construction, Individually Wrapped	200	800
327101	10	2 pieces construction, Individually Wrapped	200	800
328001	25	Individually Wrapped	200	800
329001	50	Individually Wrapped	100	600
324002	1	Bulk Pack, 50 per bag	20 x 50ea	3,000
325002	2	Bulk Pack	20 x 50ea	3,000
326002	5	Bulk Pack	10 x 50ea	1,500
327002	10	Bulk Pack	10 x 50ea	1,500
327102	10	Bulk Pack	10 x 50ea	1,500
328002	25	Bulk Pack, 25 per bag	8 x 25ea	800
329002	50	Bulk Pack	4 x 25ea	600

Reagent Reservoirs



Cat.No.	Volume (mL)	/Pack	/Case
360002	60	5	25



8 Channel



12 Channel



96 Channel



384 Channel

Cat.No.	Channel Number	Sterile	Volume (mL)	/Pack	/Case
360101	8	NO	22	5	50
360102	12	NO	14	5	50
360103	96	NO	195	5	50
360104	384	NO	185	5	50

Tips: Customizable sterilized product.

Elisa Plates(Immunoplates)



Cat.No.	Description	Spec (well)	Color	/Pack	/Case
504201	Detachable, High Binding, Clear	96	White bottom & Transparent well	5	50
514201	Undetachable, High Binding, Clear	96	Transparent	5	50

Cuvettes *New*



Cat.No.	Min Volume	Max Volume	Seam specification	/Pack	/Case
371001	1.5ml	2.5-3ml	4.5x23(mm)	100	1,000

- Suitable for visible light detection at 400 to 760 nm.

PCR Tubes & Caps

Feature

- Free of Dnase and Rnase, human DNA and PCR inhibitors
- Autoclavable



PCR Tube

Cat.No.	Volume (mL)	/Pack	/Case
401001	0.2	1,000	10,000



PCR 8-Strip Tubes with Individual Caps attached

Cat.No.	Volume (mL)	/Pack	/Case
404001	0.2	120	1,200

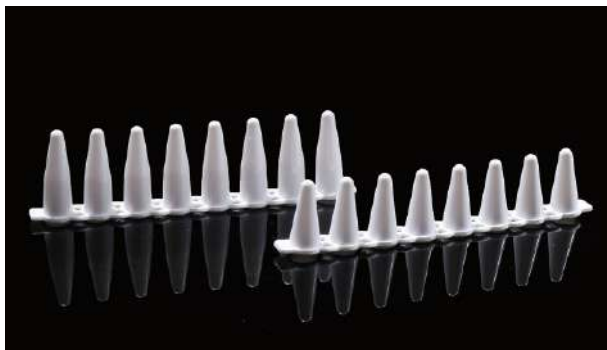

PCR 8-Strip Tubes, White

Cat.No.	Volume (mL)	/Pack	/Case
403112	0.1	125	1,250
403012	0.2	125	1,250

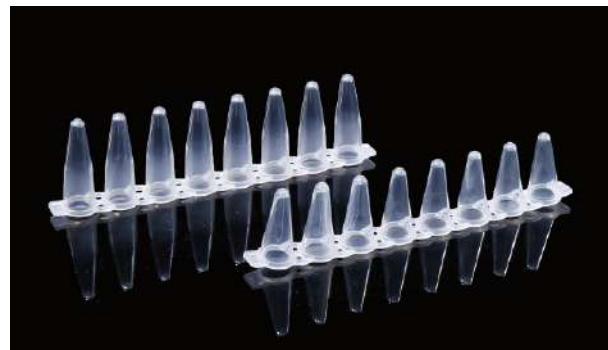

PCR 8-Strip Tubes, Transparent

Cat.No.	Volume (mL)	/Pack	/Case
403102	0.1	125	1,250
403002	0.2	125	1,250



PCR 8-Strip Tube Caps

Cat.No.	Cap Type	/Pack	/Case
406012	Flat	125	1,250

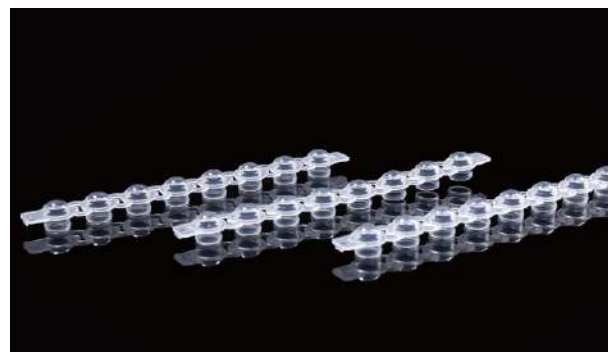

PCR 8-Strip Tube Caps

Cat.No.	Cap Type	/Pack	/Case
406112	Domed	125	1,250

PCR Plates

Feature

- Made from high quality polypropylene to ensure the minimal loss of reaction solution.
- Flat surface, thick and solid, not easy to deform
- Elevated edge of the hole can better prevent cross contamination
- Compatible with NEST pressure sensitive film, self-adhesive film and hot sealing film
- Autoclavable



Cat.No.	Volume (mL)	Skirt Type	Cut Position	/Pack	/Case
402712	0.1	Semi Skirt	H12	10	50

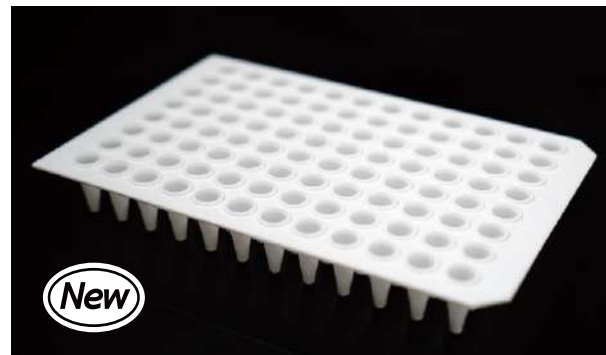

Cat.No.	Volume (mL)	Skirt Type	Cut Position	/Pack	/Case
402812	0.1	No Skirt	A12/H12	10	50



Cat.No.	Volume (uL)	Skirt Type	Cut Position	/Pack	/Case
409013	40	Semi Skirt	A24/P24	10	50

PCR Adaptation Table

Brand	Cat.No.	402712	402812	409013
	Instrument Model			
Roche	lightcycler 480	402712		
	lightcycler 480 II	402712		409013
	lightcycler 96	402712		
	lightcycler nano		402812	



Cat.No.	Volume (mL)	Skirt Type	Cut Position	/Pack	/Case
402201	0.2	No Skirt	H12	25	100

- Elevated wells plate is designed to reduce the risk of cross contamination.
- Easy to open.



Cat.No.	Volume (mL)	Skirt Type	Cut Position	/Pack	/Case
402501	0.1	Full Skirt	H1	25	100

- Stronger construction and more space for labeling.

PCR Plates without Skirt remove

The low profile design minimized the condensate contamination and evaporation of reaction solution.

PCR Plates with Skirt remove

Stronger construction and more space for labeling.



Cat.No.	Volume (mL)	Skirt Type	Cut Position	/Pack	/Case
402101	0.1	No Skirt	H12	25	100



Cat.No.	Volume (mL)	Skirt Type	Cut Position	/Pack	/Case
402001	0.2	No Skirt	H1	25	100

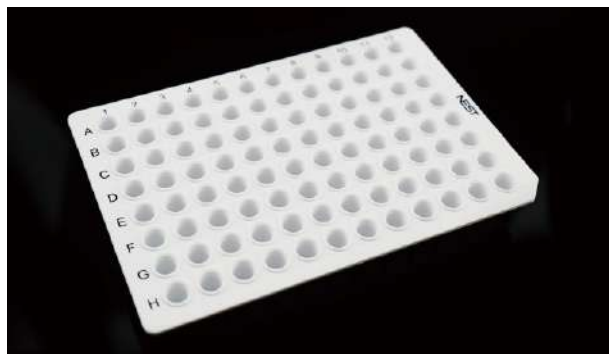

Cat.No.	Volume (mL)	Skirt Type	Cut Position	/Pack	/Case
402111	0.1	No Skirt	H12	25	100



Cat.No.	Volume (mL)	Skirt Type	Cut Position	/Pack	/Case
402011	0.2	No Skirt	H1	25	100



Cat.No.	Volume (mL)	Skirt Type	Cut Position	/Pack	/Case
402401	0.1	Semi Skirt	A1	25	100

Compatible with ABI machine



Cat.No.	Volume (mL)	Skirt Type	Cut Position	/Pack	/Case
402301	0.2	Semi Skirt	A12	25	100

PCR Plates



Cat.No.	Volume (mL)	Skirt Type	Cut Position	/Pack	/Case
402601	0.2	Semi Skirt	A12	25	100

Compatible with ABI machine



Cat.No.	Volume (mL)	Skirt Type	Cut Position	/Pack	/Case
402411	0.1	Semi Skirt	A1	25	100

PCR Rack



Feature

- Fir for all NEST PCR products
- Stackable
- Autoclavable

Cat.No.	Specification	/Pack	/Case
407001	8*12, One Rack + One Lid	1	25
407101	8*12, Five Racks + One Lid	5	25

PCR Sealing Film & Scraper



Cat.No.	Size (mm)	/Pack
411001	70*78	1



Cat.No.	Specification	/Pack	/Case
410001	Standard Sealing Film, -20°C To 110°C	100	500
410011	Advanced Sealing Film, -70°C To 100°C	100	500

Brand	Instrument Model	PCR Tube		PCR Plate			
Applied Biosystems®	2720	401001	403002/404001		402001	402301	402601
	9600	401001	403002/404001		402001	402301	402601
	9700	401001	403002/404001		402001	402301	402601
	9800Fast			403102			
	Veriti/Fast			403102		402401	402101
	7000	401001	403002/404001		402001	402301	402601
	7300	401001	403002/404001		402001	402301	402601
	7500/Fast	401001	403002/404001	403102	402001	402301	402601
	7700	401001	403002/404001		402001	402301	402601
	7900HT/Fast	401001	403002/404001	403102	402001	402301	402601
	StepOne			403102		402401	402812
	StepOnePlus			403102		402401	402812
	ProflexPCRSysytem	401001	403002/404001		402001	402301	402601
	QuantStudio 12K	401001	403002/404001		402001	402301	402601
	ViiA7/Fast	401001	403002/404001	403102	402001	402301	402601
	3100				402001	402301	402601
Eppendorf®	3130				402001	402301	402601
	3700				402001	402301	402601
	3730/3730x				402001	402301	402601
	Mastercycler®	401001	403002/404001		402001	402301	402501
	Mastercycler® ep realplex	401001	403002/404001		402001	402301	402501
	Mastercycler ep	401001	403002/404001		402001	402301	402501
	Mastercycler nexus	401001	403002/404001		402001	402301	402501
	Mastercycler nexus eco	401001	403002/404001		402001	402301	402501
	Mastercycler nexus flat	401001					
	Mastercycler nexus flat ec	401001	403002/404001				
	Mastercycler nexus gradie	401001	403002/404001		402001	402301	402501
	Mastercycler nexus gradie	401001	403002/404001		402001	402301	402501
	Mastercycler nexus GSX1	401001	403002/404001		402001	402301	402501
	Mastercycler nexus GSX1	401001	403002/404001		402001	402301	402501
	Mastercycler nexus SX1	401001	403002/404001		402001	402301	402501
	Mastercycler nexus SX1e	401001	403002/404001		402001	402301	402501
Stratagene	Mastercycler pro/S	401001	403002/404001		402001	402301	402501
	Mx3000®	401001	403002/404001		402001	402301	
	Mx3000P®	401001	403002/404001		402001	402301	
	Mx3005®	401001	403002/404001		402001	402301	
Agilentc	Mx4000®	401001	403002/404001		402001	402301	
	SureCycler®8800	401001	403002/404001	403102	402001	402301	402401
	ARIA MX G8830A						402812
	Opticon2			403102		402501	402812
Qiagen®	Flexigene®	401001	403002/404001		402001	402301	
	Rotor-Gene® Q	401001					

Brand	Instrument Model	PCR Tube		PCR Plate			
Biorad® / MJ Research®	C1000™ Touch™	401001	403002/404001	402001	402301	402501	
	DNA Engine Dyad®/Dyad	401001	403002/404001	402001	402301	402501	
	Engine Tetrad®2	401001	403002/404001	402001	402301	402501	
	MyCycler™	401001	403002/404001	402001	402301	402501	
	PTC-100®	401001	403002/404001	402001	402301	402501	
	PTC-200	401001	403002/404001	402001	402301	402501	
	PTC-225 Tetrad	401001	403002/404001	402001	402301	402501	
	S1000™	401001	403002/404001	402001	402301	402501	
	T100™	401001	403002/404001	402001	402301	402501	
	CFX Connect™	401001	403002/404001	403102	402301	402501	402101
	CFX96™ Touch/CFX96	401001	403002/404001	403102	402301	402501	402101 402812
	Chromo4™	401001	403002/404001	402001	402301	402501	
	DNA Engine Opticon®2	401001	403002/404001	402001	402301	402501	
	iCycler	401001	403002/404001	402001	402301	402501	
	iQ™5	401001	403002/404001	402001	402301	402501	
	MiniOpticon™	401001	403002/404001	402001	402301	402501	
	MyiQ™	401001	403002/404001	402001	402301	402501	
	Opticon			403102		402501	402101
	miniOpticon						402812
	BaseStation™				402301	402501	
	MJ research option						402812
Analytik Jena / Biometra	FlexCycler	401001	403002/404001	403102	402001	402501	402101
	T1 Thermal Cycler	401001	403002/404001	403102	402001	402501	402101
	TGradient	401001	403002/404001	403102	402001	402501	402101
	Tpersonal	401001	403002/404001	403102	402001	402501	402101
	TProfessional/Basic	401001	403002/404001	403102	402001	402501	402101
	TProfessional/Standard	401001	403002/404001	403102	402001	402501	402101
	TProfessional/TIRO	401001	403002/404001	403102	402001	402501	402101
	TRobot	401001	403002/404001	403102	402001	402501	402101
	Uno	401001	403002/404001	403102	402001	402501	402101
	Uno II	401001	403002/404001	403102	402001	402501	402101
	q TOWER	401001	403002/404001		402001	402501	
	SpeedCycler ²	401001	403002/404001		402001	402501	
	TOptical	401001	403002/404001		402001	402501	
	Multiblock System	401001	403002/404001		402001	402501	402101
	T1 Thermal Cycler	401001	403002/404001		402001	402501	402101
	Omn-E	401001	403002/404001		402001	402501	402101
	Omnigene	401001	403002/404001		402001	402501	402101
Thermo Hybaid	PCR Express	401001	403002/404001		402001	402501	402101
	PCR Sprint	401001	403002/404001				
	Px2	401001	403002/404001		402001	402501	402101
	PxE	401001	403002/404001		402001	402501	402101
	Touchdown	401001	403002/404001		402001	402501	402101
	3Prime	401001	403002/404001				

Brand	Instrument Model	PCR Tube		PCR Plate			
Techne®	3PrimeG	401001	403002/404001				
	3PrimeX	401001	403002/404001				
	Cyclogene™	401001	403002/404001	402001	402301	402501	
	Flexigene™	401001	403002/404001	402001	402301	402501	
	Genius	401001	403002/404001	402001	402301	402501	
	Genius Quad	401001	403002/404001	402001	402301	402501	
	Genius(TC412)	401001	403002/404001	402001	402301	402501	402101
	Prime	401001	403002/404001	402001	402301	402501	
	Prime Elite	401001	403002/404001	402001	402301	402501	
	Prime Elite Satellite	401001	403002/404001	402001	402301	402501	
	PrimeG	401001	403002/404001	402001	402301	402501	
	Touchgene®Gradient(TC5	401001	403002/404001	403102	402301	402501	
	Touchgene®X	401001	403002/404001	403102	402301	402501	
	PrimeQ	401001	403002/404001		402301	402501	
	Quantica®	401001	403002/404001		402301	402501	
	Deltacycler I	401001	403002/404001		402301		402101
Ericom	Single Block	401001	403002/404001		402301		402101
	Twin Block	401001	403002/404001		402301		402101
MWG®	Primus 96	401001	403002/404001	403102	402301	402501	
PeqLab®	peqSTAR 96	401001	403002/404001		402301	402501	
SensoQuest	Thermocycle 96	401001	403002/404001		402301	402501	
Stratagene	Robocycler	401001	403002/404001		402301	402501	
TaKaRa®	TP240	401001	403002/404001		402301	402501	
	TP3000	401001	403002/404001	403102	402301	402501	402101
Amersham®	MegaBACE®500				402301	402501	
GE®	MegaBACE1000				402301	402501	402201
Beckman Coul	CEQ™				402301		
Transgenomic	WAVE®System				402301	402501	
天隆	TL988-IV						402812
Biorad® / MJ Research®	C1000™ Touch™	401001	403002/404001		402301	402501	
	DNA Engine Dyad®/Dyad	401001	403002/404001		402301	402501	
	Engine Tetrad®2	401001	403002/404001		402301	402501	
	MyCycler™	401001	403002/404001		402301	402501	
	PTC-100®	401001	403002/404001		402301	402501	
	PTC-200	401001	403002/404001		402301	402501	
	PTC-225 Tetrad	401001	403002/404001		402301	402501	
	S1000™	401001	403002/404001		402301	402501	
	T100™	401001	403002/404001		402301	402501	
	CFX Connect™	401001	403002/404001	403102	402301	402501	402101
	CFX96™ Touch	401001	403002/404001	403102	402301	402501	402101
	Chromo4™	401001	403002/404001		402301	402501	
	DNA Engine Opticon®2	401001	403002/404001		402301	402501	
	iCycler	401001	403002/404001		402301	402501	
	iQ™5	401001	403002/404001		402301	402501	
	MiniOpticon™	401001	403002/404001		402301	402501	

Brand	Instrument Model	PCR Tube		PCR Plate				
	MyiQ™	401001	403002/404001		402001	402301	402501	
	Opticon			403102			402501	
	BaseStation™					402301	402501	402101
	Opticon2			403102			402501	402101
Analytik Jena / Biometra	FlexCycler	401001	403002/404001	403102	402001	402301	402501	402101
	T1 Thermal Cycler	401001	403002/404001	403102	402001	402301	402501	402101
	TGradient	401001	403002/404001	403102	402001	402301	402501	402101
	Tpersonal	401001	403002/404001	403102	402001	402301	402501	402101
	TProfessional/Basic	401001	403002/404001	403102	402001	402301	402501	402101
	TProfessional/Standard	401001	403002/404001	403102	402001	402301	402501	402101
	TProfessional/TIRO	401001	403002/404001	403102	402001	402301	402501	402101
	TRobot	401001	403002/404001	403102	402001	402301	402501	402101
	Uno	401001	403002/404001	403102	402001	402301	402501	402101
	Uno II	401001	403002/404001	403102	402001	402301	402501	402101
	q TOWER	401001	403002/404001		402001	402301	402501	
	SpeedCycler²	401001	403002/404001		402001	402301	402501	
Thermo Hybrid	TOptical	401001	403002/404001		402001	402301	402501	
	Multiblock System	401001	403002/404001		402001	402301	402501	402101
	T1 Thermal Cycler	401001	403002/404001		402001	402301	402501	402101
	Omn-E	401001	403002/404001		402001	402301	402501	402101
	Omnigene	401001	403002/404001		402001	402301	402501	402101
	PCR Express	401001	403002/404001		402001	402301	402501	402101
	PCR Sprint	401001	403002/404001					
	Px2	401001	403002/404001		402001	402301	402501	402101
	PxE	401001	403002/404001		402001	402301	402501	402101
	Touchdown	401001	403002/404001		402001	402301	402501	402101
	3Prime	401001	403002/404001					
	3PrimeG	401001	403002/404001					
Techne®	3PrimeX	401001	403002/404001					
	Cyclogene™	401001	403002/404001		402001	402301	402501	
	Flexigene™	401001	403002/404001		402001	402301	402501	
	Genius	401001	403002/404001		402001	402301	402501	
	Genius Quad	401001	403002/404001		402001	402301	402501	
	Genius(TC412)	401001	403002/404001		402001	402301	402501	402101
	Prime	401001	403002/404001		402001	402301	402501	
	Prime Elite	401001	403002/404001		402001	402301	402501	
	Prime Elite Satellite	401001	403002/404001		402001	402301	402501	
	PrimeG	401001	403002/404001		402001	402301	402501	
	Touchgene®Gradient(TC412)	401001	403002/404001	403102	402001	402301	402501	402101
	Touchgene®X	401001	403002/404001	403102	402001	402301	402501	402101
	PrimeQ	401001	403002/404001		402001	402301	402501	
	Quantica®	401001	403002/404001		402001	402301	402501	

Deep Well Plates



Deep Well Plates

Cat.No.	Volume (mL)	Well Number	Well Type	Shape Type	/Pack	/Case
504102	3.5	48	Round Well	U	5	50
504002	4.6	48	Square Well	U	5	50
500101	0.36	96	Round Well	V	5	50
501102	0.4	96	Round Well	U	5	50
501101	0.5	96	Round Well	V	5	50
502101	1	96	Round Well	V	5	50
502102	1	96	Round Well	U	5	50
503102	2	96	Round Well	U	5	50
501002	1	96	Square Well	U	5	50
502002	1.6	96	Square Well	U	5	50
503001	2	96	Square Well	V	5	50
503002	2.2	96	Square Well	U	5	50

96 Round Well Silicon Mat

Cat.No.	Well Type	Description	/Pack	/Case
506003	Square	For most 96 well Square well plates	10	50
506004	Square	For most 96 well Square well plates, Pierceable	10	50
506005	Round	For 96 well Round well plates, 0.3~1.3ml, Pre-Slit	10	50
506006	Round	For 96 well Round well plates 2ml (Nest 503102)	10	50

Deep Well Plates & Plastic Comb New

Cat.No.	Description	/Pack	/Case
510001	24 Square Wells (16ml) Deep well Plates, V shape	1	24
509001	Plastic Comb 67.6*13.5 mm	/	/
510011	510001*1 & 509001*1	1	24

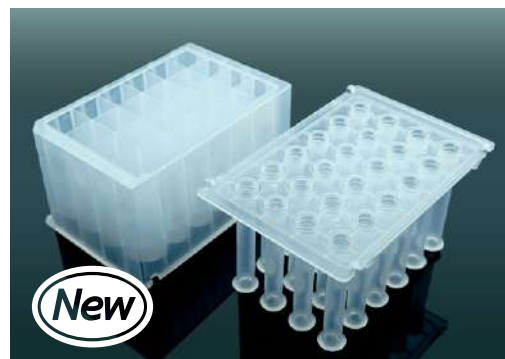

Petri Dishes

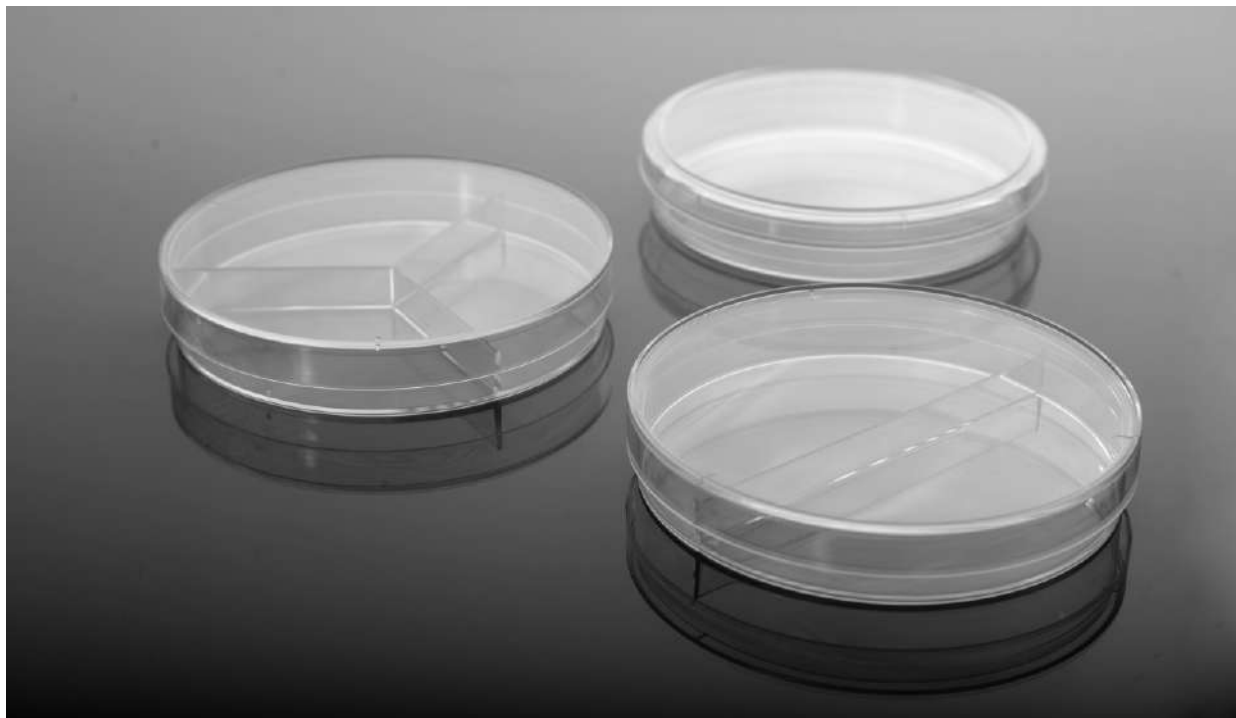

• Sterilized by E-Beam, SAL=10⁻⁶

RODAC Dish New

Cat.No.	Spec(mm)		Volume (mL)	/Pack	/Case
	Diameter	Height			
722011	65	15	13-15	20	25

Cat.No.	Spec(mm)		Volume (mL)	/Pack	/Case
	Diameter	Height			
706011	35	12	5	20	25
754001	60	15	15	20	25
752001	90	15	40	20	25
752002	90	15	40 (Double Packaged)	20	25
752004	90	15	40	10	50
752003	90	15	40	5	100
752011	90	15	20 x 2 compartments	20	25
752021	90	15	13 x 3 compartments	20	25
752031	90	15	10 x 4 compartments	20	25
752401	100	20	40	20	15
715011	150	15	60	10	10
755001	150	25	/	5	20

L-Spreader New

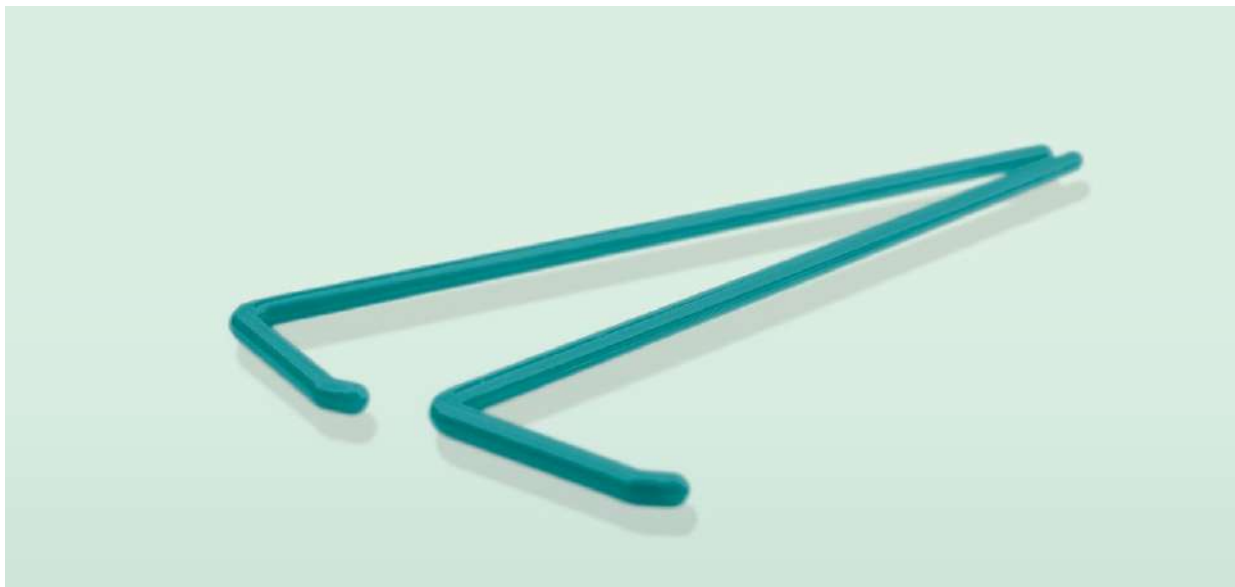

Cat.No.	Name	Color	/Pack	/Case
711001	L-Spreader	Blue	200	2,000

Innoculating Needles / Loops

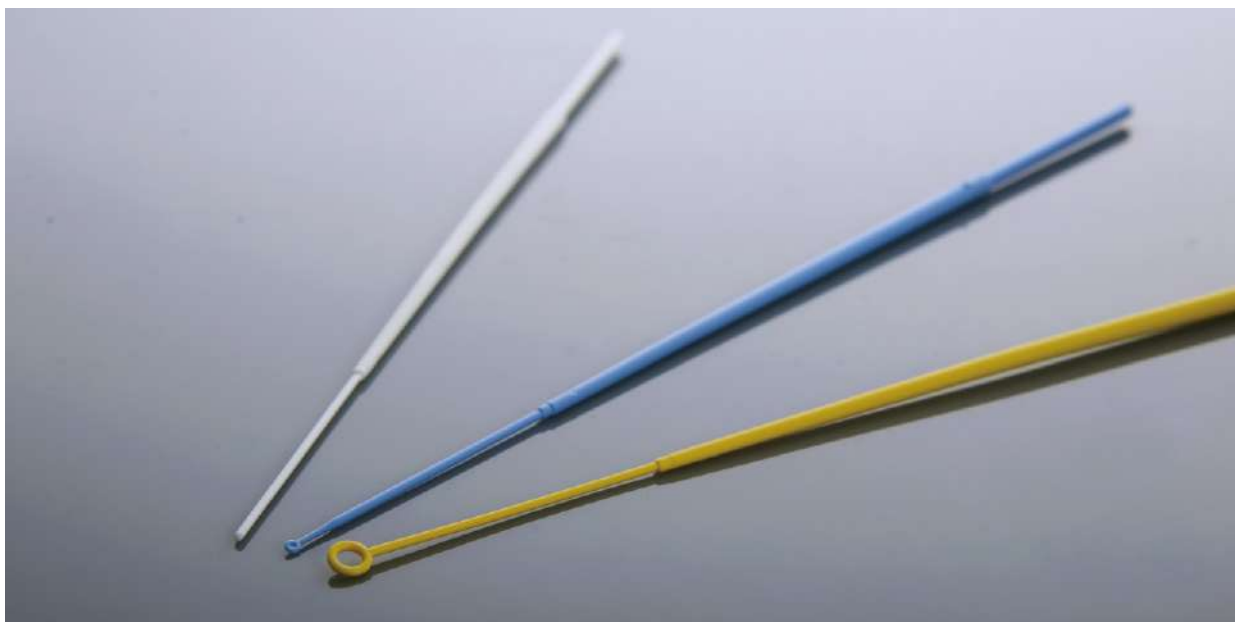

Feature

- Sterilized by Ethylene Oxide
- Easy-tear individual packaging

Cat.No.	Volume (μL)	Name	Color	/Pack	/Case
716001	/	Inoculating Needle	White	400	4,000
717101	1	Inoculating Loop	Blue	400	4,000
718201	10	Inoculating Loop	Yellow	400	4,000

Nonwoven Masks



Cat.No.	Name	Size (±0.5cm)	Color	/Pack	/Case
922001	Three-layer PP Non-woven Lab Protection Mask	17.5 x 9	Dark Gray	50	500
922101	Four-layer PP Activated Carbon Non-woven Lab Protection Mask	17.8 x 9.3	Blue	50	500

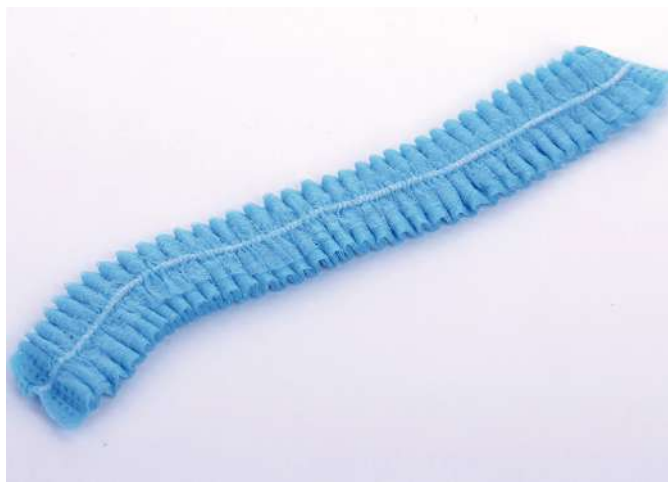

Mushroom Caps

Cat. No.	Name	/Pack	/Case
921001	Blue Mushroom Cap	100	1,000
921101	White Mushroom Cap	100	1,000



Disposable PP non-woven Shoe covers

Cat. No.	Size	/Pack	/Case
923001	42 * 17cm	100	1,000

Nitrile Examination Gloves



Nitrile Powder Free Examination Gloves



Colloidal Oatmeal Coated Nitrile Gloves



Feature

- Single use only, powder free
- Made in Malaysia
- Non-Sterile
- Tensile Strength: Minimum 18.0 MPa (Before Aging)
- Palm thickness: 0.05mm

Nitrile Powder Free Examination Gloves

Cat.No.	Size	Palm Width (mm) ±4mm	Length (mm)	/Pack	/Case
902001	XS	76	Min 230mm (ASTM)	100	1,000
902011	S	86		100	1,000
902021	M	98		100	1,000
902031	L	107		100	1,000
902041	XL	115		90	900

Colloidal Oatmeal Coated Nitrile Gloves

oats extractions

Oats extractions is a patented coating recognized by the FDA as a skin protectant. Clinical studies have shown that colloidal oatmeal could reduce and control rash, dry skin.

Cat.No.	Size	Palm Width (mm) ±4mm	Length (mm)	/Pack	/Case
903011	S	84	Min 230mm (ASTM)	100	1,000
903021	M	94		100	1,000
903031	L	105		100	1,000

Latex Examination Gloves



Nitrile Powder Free Examination Gloves



Colloidal Oatmeal Coated Nitrile Gloves



Feature

- Single use only, powder free
- Made in Malaysia
- Non-Sterile
- Tensile Strength: Minimum 18.0 MPa (Before Aging)
- Palm thickness: 0.11mm

Nitrile Powder Free Examination Gloves

Cat.No.	Size	Palm Width (mm) ±4mm	Length (mm)	/Pack	/Case
901001	XS	76	Min 230mm (ASTM)	100	1,000
901011	S	86		100	1,000
901021	M	98		100	1,000
901031	L	107		100	1,000
904041	XL	115		100	1,000

Colloidal Oatmeal Coated Nitrile Gloves

oats extractions

Oats extractions is a patented coating recognized by the FDA as a skin protectant. Clinical studies have shown that colloidal oatmeal could reduce and control rash, dry skin.

Cat.No.	Size	Palm Width (mm) ±4mm	Length (mm)	/Pack	/Case
904011	S	84	Min 230mm (ASTM)	100	1,000
904021	M	94		100	1,000
904031	L	105		100	1,000

Centrifuge New

Feature

- Electronic locks. Centrifugation only when the lid is locked.
- The lid opens automatically after centrifugation.
- Fast Lifting Speed, The electronic brake
- Low Noise
- Capacitive touchpad, responsive.
- LCD display. Real-time display of speed, time and operating status.
- Centrifugal time and speed adjustable. Adjustable speed during centrifugation.
- Size: 260*220*150mm
- Voltage: 110-220V, 50-60HZ

Type	Name	Rotation Range (RPM)	Max RCF (g)	Rotor
C10609	Universal Centrifuge	500-6,000	2,400	General Rotor (1.2/05/1.5/5.0ml)
C10605	5 mL Centrifuge	500-6,000	2,400	For 5 mL Centrifuge Tubes
C11202	High - Speed Centrifuge	500-12,000	8,800	For 1.5 mL & 2.0 mL Centrifuge Tubes

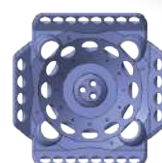

General Rotor



5 mL Centrifuge



High - Speed
Centrifuge

7° Digital Nutating Mixer New

Feature

- The adjustable and gentle motion is ideal for many staining applications;
- Includes a large platform and non-slip mat;
- Low voltage power supply provides safe cold room operation and low energy consumption;
- Continuous or timed operation with automatic switch-off;
- Continue to run by last set speed and the remaining time when the power recovered;
- Audible and visual alarm: In timed mode, alarm will sound 5 times and then the time window shows "End" and flicker 5 times when the time reaches zero.

Cat. No.	105005
Speed	2~80rpm
Speed Accuracy	1rpm
Tilt Angle	7°
Timer	0~99h59min
Platform Dimensions	307x297mm
Max. Load	0.8kg
Display	LED
Included Accessory Standard in Packaging	6 Rubber Strips
Ambient Temperature	5~40 C
Relative Humidity	≤80%
Power Supply	AC100~240V, 50 / 60Hz
Max. Power	6.5W
Dimensions	440(L)x296(W)x189(H)mm
Net Weight	7.3kg
Protection Level	IP21



Rubber Strip

Mini Metal Bath New



Feature

- Manual mode & automatic mode.
- Fast heating, with overheat protection switch to prevent overheating.
- Display setting parameters and real-time parameters simultaneously, easy to observe and use.

Range of Application	0.2/0.5/1.5/2.0ml Centrifuge tube
Temperature Range	Indoor temperature-100℃
Timeset	1-999min or 1-999sec
Temperature control accuracy	±0.1℃
Temperature uniformity	±0.3℃
Heating up time	About 5min
Touch screen	Capacitive touch screen
Display	LCD
Voltage	100-220V, 50-60HZ
Size	157*115*100mm (L*W*H)
Weight	About 0.5kg

Mini Vortex Mixer New



Feature

- Extremely compact and easy operation;
- Powerful vortexing for tubes up to 30mm;
- Head is made of durable material to ensure long life;
- Refined steel base is designed to ensure product stability.

Cat. No.	105003
Oscillation Mode	Circumference Oscillation
Orbital Diameter	Φ4.5mm
Max. Capacity	80mL
Max. Tube Diameter	Φ30mm
Speed	3000rpm
IP rating (DIN EN 60529)	IP40
Ambient Temp.	5~40℃
Outside Dimensions	Φ96xH85mm
Power	5W
Power Supply	AC100~240V,50/60Hz
Weight	0.55kg

Variable Speed Tube Revolver With Digital Display New

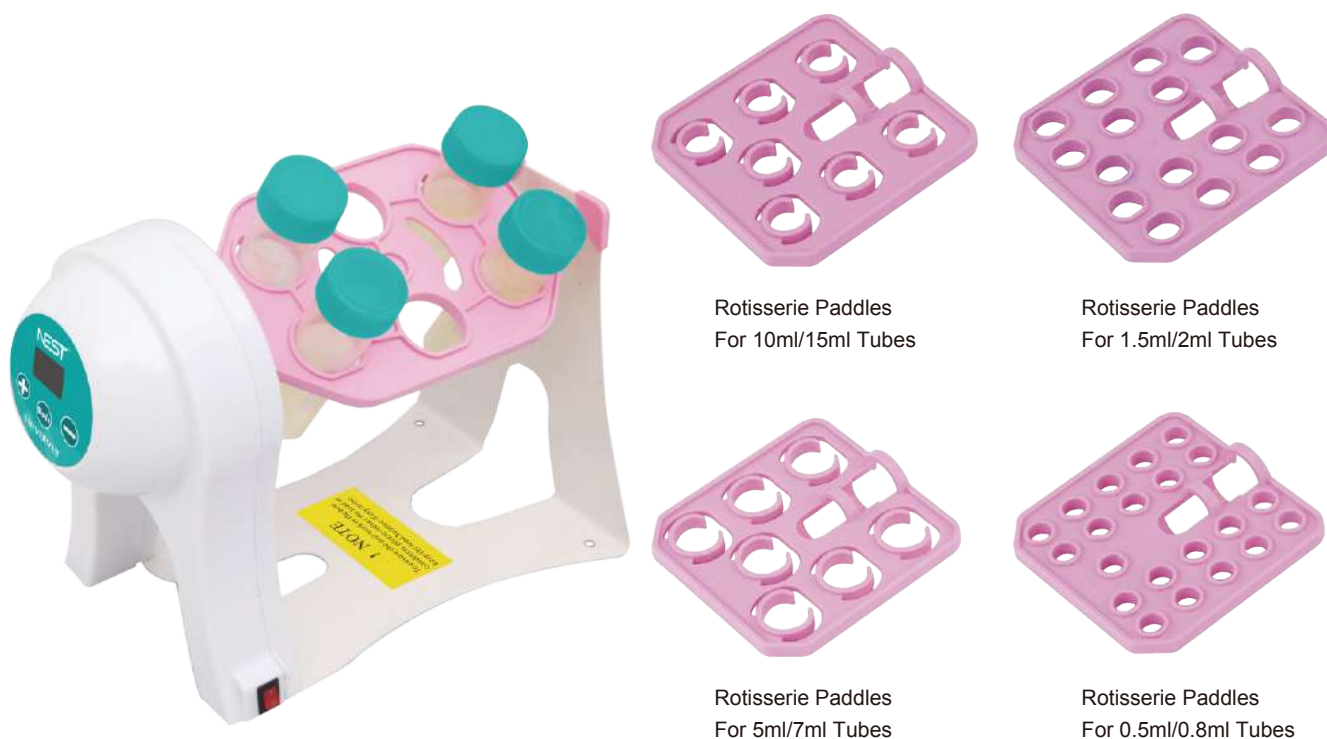

Feature

- Small footprint, "Plug and Play" operation;
- Includes five different interchangeable rotisseries;
- Rotation direction can be changed by slightly touching the rotisseries;
- Paddle angle is adjustable for different mixing purposes;
- High quality, maintenance-free motor with quiet operation.



Rotisserie Paddles
For 50ml Tubes

Cat. No.	105004
Rotation Speed	10~40rpm
Capacity	84x0.5ml tubes, 60x1.5ml/2.0ml tubes, 28x5ml/7ml tubes, 24x10ml tubes, 6x50ml tubes
Holder for Tubes Standard Configuration	Rotisserie Paddles for 10ml/15ml Tubes 2pcs Rotisserie Paddles for 5ml/7ml Tubes 2pcs Rotisserie Paddles for 1.5ml/2ml Tubes 2pcs Rotisserie Paddles for 0.5ml/0.8ml Tubes 2pcs Rotisserie Paddles for 50ml Tubes 1pcs
Ambient	4~60℃
Outside Dimensions	260(W)x148(D)x195mm(H)
Power	10W
Power Supply	AC100V~240V 50Hz/60Hz
Weight	1kg

Standard Mini Roller New



Standard Mini Roller (6 Rollers)



Standard Mini Roller (11 Rollers)

Feature

- Variable speed to accommodate numerous applications;
- Anti-corrosive and wear-resistant construction for use in humid and CO₂ environments.
- Remote control box makes it easy to operate the unit while it is in an incubator.

Product Name	Standard Mini Roller (11 Rollers)	Standard Mini Roller (6 Rollers)
Cat. No.	105007	105006
Included Accessory Standard In Packaging	Rollers: 11 O Ring (23.5x3.6mm): 20 O Ring (13.2x2.7mm): 20	Rollers: 6 O Ring (23.5x3.6mm): 20 O Ring (13.2x2.7mm): 20
Roller Speed	0.5~80rpm	0.5~80rpm
Operating Mode	Way Forward	Way forward
Roller Dimensions(DXL)	Φ28mmx259mm	φ28mmx259mm
Available Tubes or Bottles	Max. Ø120mm Bottles; Tubes	Max. Ø120mm bottles; tubes
Positions	Centrifuge Tubes Can Be Placed Randomly Or Three 1500ml Standard Bottles	Centrifuge tubes can be placed randomly or three 1500ml standard bottles
Max.Load	6.5kg	6.5kg
Ambient	5℃~60℃	5℃~60℃
Relative Humidity	≤95%	≤95%
Display	Led	LED
Timer (Control Box)	999min Or Continuous	/
Outside Dimensions(WxDxH)	378mmx360mmx72mm	378mmx360mmx72mm
Power	10w	10W
Power Supply	Ac100~240v,50/60hz	AC100~240V,50/60Hz
Weight	6.5kg	6.5kg

CO₂ Orbital Shaker

New

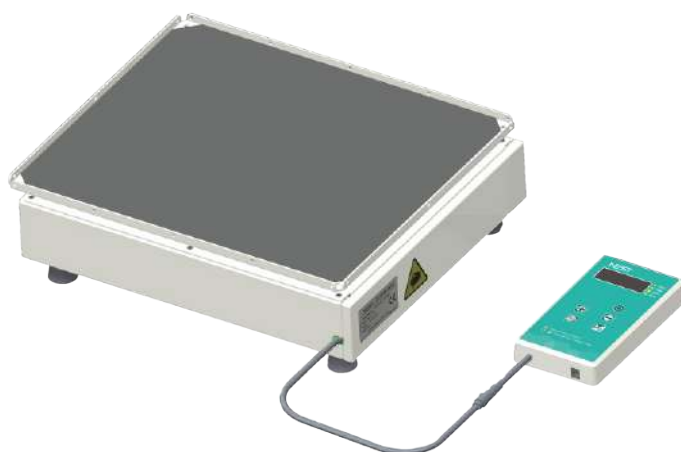

Feature

- Orbital shaking through magnetic power eliminates the need to replace belts;
- Small footprint ideal for use in a CO₂ incubator;
- Specially treated mechanical components protect up to 20% CO₂ and 95% humidity conditions;
- Convenient external control box with LED display allows for easy adjustments without opening the chamber door;
- Minimal heat dissipation assures conditions within the CO₂ chamber are not effected;
- CO₂ resistant shaker can be used outside of CO₂ incubator for maximum value.

Cat. No.	105008 (No Accessories) / 105009 (Contain Accessories)	
Speed Range	30rpm~300rpm	
Timer	0~99h59min (0,continuous)	
Orbit Diameter	Φ19mm	
Platform Dimensions	355mmx300mm	
Max.Capacity	50mlx30 / 100mlx15 / 150mlx15 / 200mlx15 / 250mlx15 500mlx9 / 1000mlx6 / 2000mlx4 / 3000mlx2 / 5000mlx1	
Display	LED	
Max.Load	6kg	
Ambient	Temp.: 5 ~ 60 Humidity: <99%RH	
Outside Dimensions(WxDxH)	Machine Body: 360 x 300 x 96mm Control Box: 360 x 105 x 75mm The Unit: 360 x 405 x 96mm	
Power	30W	
Power Supply	AC100~240V, 50Hz/60Hz	
Weight	Machine Body :17.5kg Control box: 1kg	
Accessories List ▲	100ml Flask Clamp * 2	250ml Flask Clamp * 4
	500ml Flask Clamp * 4	1000ml Flask Clamp * 2
	2000ml Flask Clamp * 2	Aluminum Platform * 1
	Tips: Only cat. No. 105009 contain these accessories.	

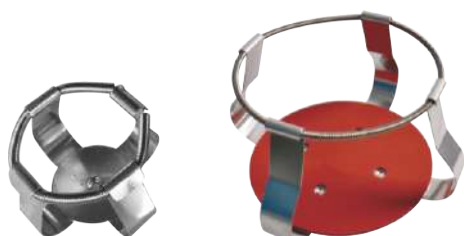

Flask Clamp



Aluminum Platform

Flask Clamp Feature

Made of polished stainless steel sheet. They can be fixed on any platform of all models of incubator shakers.

Cat.No.	Name
105901 ▲	100ml Flask Clamp * 2
	250ml Flask Clamp * 4
	500ml Flask Clamp * 4
	1000ml Flask Clamp * 2
	2000ml Flask Clamp * 2
	Aluminum Platform * 1
105902 ▲	100ml Flask Clamp
105903 ▲	250ml Flask Clamp
105904 ▲	500ml Flask Clamp
105905 ▲	1000ml Flask Clamp
105906 ▲	2000ml Flask Clamp
105907 ▲	Aluminum Platform 300mm*360mm

▲ Make To Order



ISO 9001



ISO 11137



ISO 13485



+569 82684883

ventas@labmedltda.cl

www.labmedltda.cl

Antonio Varas 175, oficina 402, Providencia
Ciudad - Santiago - Chile

